



SHUTTER PRODUCT MANUAL

www.exusshutters.com

Tel: 1-877-228-EXUS

V. 20230222

Contents

NATURAL	1	MOUSE HOLE	35
TEXTURE	2	LIBERTY ARCH	35
EXUS PRODUCTS	3	TILT RODS	36
FRAME CHART	6	HINGES	37
FRAME PROFILES – WOOD SHUTTERS	7	DIVIDER RAIL.....	38
FRAME PROFILES – PREMIUM FAUX	9	TOP AND BOTTOM RAILS	39
WOOD SHUTTER SPECIFICATIONS.....	12	T POST	40
STANDARD COLOR CHART	14	BAY POST	41
EXTENDED COLOR CHART	15	CORNER POST	43
MEASURING GUIDELINGS.....	16	PANEL CONFIGURATIONS.....	45
PARTS OF EXUS SHUTTERS	26	BYPASS SHUTTERS	47
PARTS OF PANEL	27	BI-FOLD SHUTTERS.....	48
LOUVERS.....	28	TRACK OPENING CONFIGUTATION	49
LOUVER MINIMUM CLEARANCE	29	FRENCH DOOR	51
FRAME SIDES.....	30	CAFE SHUTTER	52
DETERMINE THE RIGHT LOUVER SIZE.....	31	COMMON SPECIAL SHUTTER.....	53
FRAME FLANGE	32	DOUBLE HUNG	55
BUILD OUT.....	32	RAISED PANEL	56
HOFFMAN KEYS.....	33	OTHER SPECIALTY SHAPES	57
FRAME EXTENSION	32	SHUTTER WARRANTY	58
STILES.....	34	ORDER FORMS	60

NATURAL

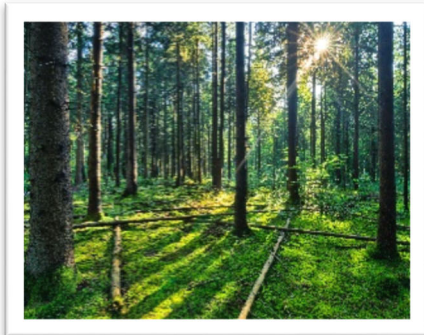

Exus wood shutters are made from a range of natural timbers. We select hardwood especially for use in shutters due to its many qualities including its resistance to bowing and warping when kiln dried properly.

Furniture Grade Hardwood is sourced from trees planted and grown in the Northern Hemisphere specifically for the purpose of manufacturing quality furniture, blinds, and shutters.



Our hardwood is kiln dried in a moisture controlled environment to ensure stability of the shutters. It is a naturally medium density timber that is ideal for shutters because it's not too heavy, but still offering stability to last for years.

We use the most advanced finger jointing system available in the market on our Linden Tree Paints and Stains. This allows us to control waste and help the environment. We laminate long pieces of finger jointed wood together and vertically cut the wood to hide the joints. This allows us to have longer and straighter wood pieces than ever before.



Exus wood shutters have variations of grain and color which are inherent in the beauty of all woods. Every style has its own distinctive character of texture, grain, color, and pattern which bring the artisan look of handcrafted shutters into your home.



We incorporate an intense sorting process for all stained shutters and pay particular attention to natural wood characteristics in our Heartland Rustic line. Heartland Rustic material contains the natural flaws in wood to give a warm natural look. This process of hand selecting the rustic hardwood material mixed with the difficulty of finishing the surface makes this shutter a more labor intensive product.

TEXTURE

Wood Characteristics

There are many noticeable characteristics of any wood, which means no two pieces are alike. We have a list of variations that are considered defects for warranty issues:

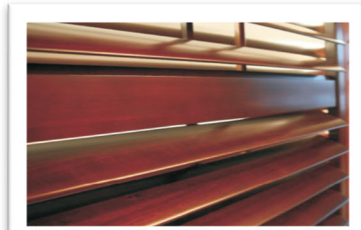

Grain

The size, direction and appearance of fibers will vary depending on where the cut is made from within the tree.

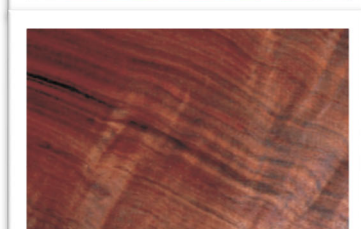

Tiger Striping

Directional grain pattern change

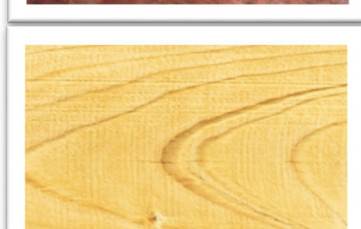

Burl

Irregular growth formed on the outer edge of the tree

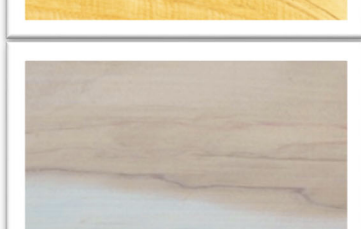

Mineral Marks

Minerals may provide dark or discolored areas which the tree extracts from the soil; they may be blackish blue streaks or stains.



Knots

Solid knots less than 3/8" are allowed, but they can vary in size, shape structure and color

Exus stain shutters do have slight variations in color tones and grain pattern that are within r industry standard.



EXUS PRODUCTS

Exus offers an extensive selection of shutter options. From multiple product lines to a variety of finishes, and every imaginable shape, Exus has everything a shutter company can offer. If the color you desire is not in our sample case, you may either mail a painted or stained sample piece of wood to our office for a custom finished shutter. As an easier option, we proudly feature all of the Sherwin Williams paint colors without the need for a sample being sent for matching.

Linden Tree/Linden Tree Stain

The Linden Tree line features our core product. The limited lifetime warranty on the paint finishes and a three year warranty on the stain finishes are the best available industry wide. This product is designed for years of trouble free performance with a beauty second to none. Our extensive list of standard color selections combined with our expert custom matching ability make the possibilities endless.

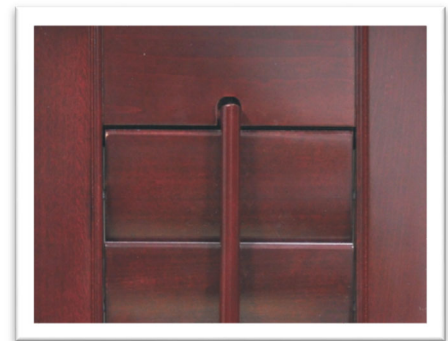

LindenTree Premier

Linden Tree Premier is our flat louver shutter. We feature 3" and 4" flat, interlocking louvers. This provides maximum privacy and room darkening with a beautiful contemporary look.

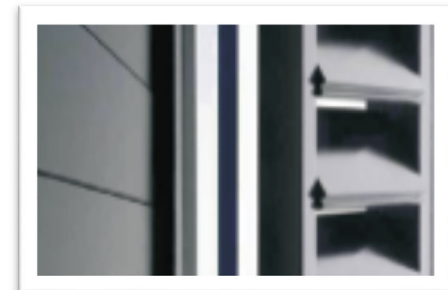

Venicci

Venicci has an antique glaze finish which resembles faux paint strokes. The finish will remind you of an Italian Country Villa and carries great designer appeal. It is unique to the industry and only available in custom colors. A sample is required for a beautiful match.

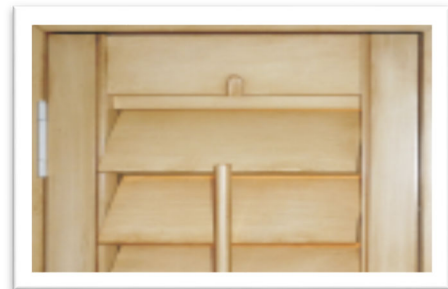

Sonora

Sonora shutters display the beautiful southwest characteristics of sandblast or wire brush finish. Hand scraping, or our high level sand blasting process gives the wood that rough, natural look. Perfect for Southwest motifs.



Chateau

Our Chateau line carries a distressed finish complete with worm holes and markings. This shutter features levels of distress from medium to heavy. Round corners on the louvers and edges are available and give a distinct look. It is easy to believe that this product was made decades ago.

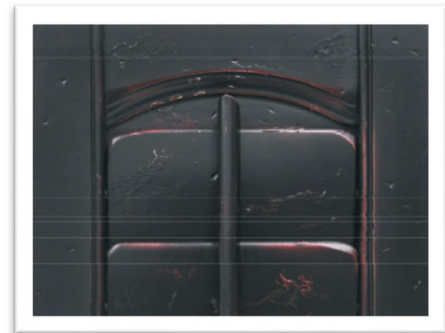

Heartland Rustics

This unique Exus product gives warmth and that rustic feel to any room it is installed in. We hand select each piece individually to ensure the correct blend of natural knot holes and imperfections. This product can be ordered in any of the standard stain colors or custom matched for any décor.

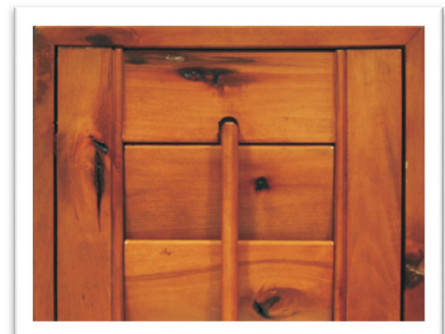

Premium Faux

This product is the perfect pairing of technology and beauty. Designed to perform, beautifully built to last. Our aluminum reinforced louvers and stiles add strength and durability to a product that will give lasting beauty over the decades. Moist areas and harsh conditions provide no challenge to this shutter. All standard and custom paint colors are available.



Deco Sill Cap – Wood

Deco sill caps are optional and can be used to cover an existing window sill, or create a sill where one doesn't exist for a completely finished look at the bottom of the shutter. The picture below shows our Heartland Rustic Shutter with a deco sill cap.

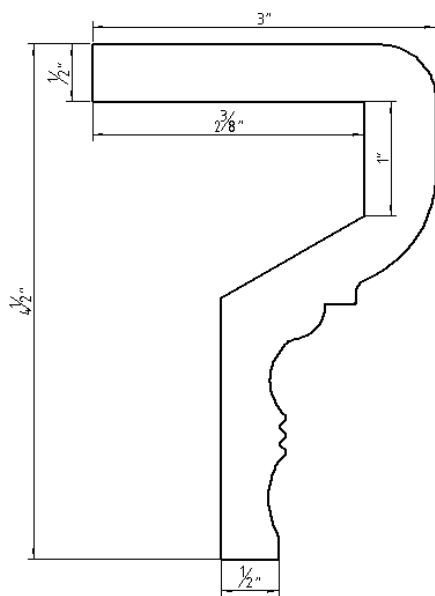

Wood
Deco Sill Cap - IM

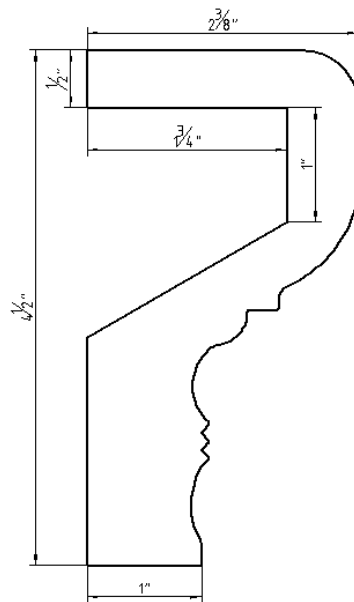

Wood
Deco Sill Cap - OM

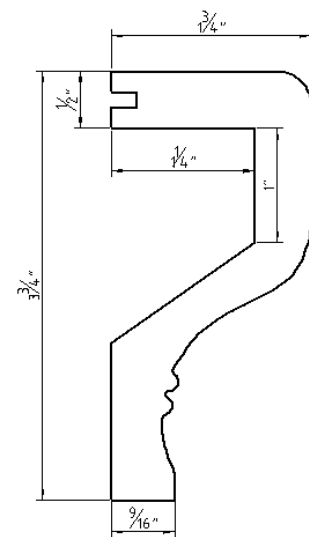

Premium Faux
Deco Sill Cap



FRAME CHART – For square footage calculation

Frames	Dimensions to Add to Window Opening Size When Using	
	4 Sided Frames	3 Sided or 3SPB Frames
Wooden Frames		
Beaded Z, IM	(Width + 1") x (Height + 1")	(Width + 1") x (Height + 1/2")
Bull Nose Z/Deco Z, IM	(Width + 2") x (Height + 2")	(Width + 2") x (Height + 1")
Medium Crown Z/Shaker Z, IM	(Width + 3") x (Height + 3")	(Width + 3") x (Height + 1 1/2")
Large Crown Z/Large Shaker Z, IM	(Width + 4 1/2") x (Height + 4 1/2")	(Width + 4 1/2") x (Height + 2 1/4")
Bull Nose/Colonial Tilt Out Z, IM	(Width + 1 1/2") x (Height + 1 1/2")	(Width + 1 1/2") x (Height + 3/4")
Hang Strip	Width x Height	Width x Height
All L Frames, OM	(Width + 2 3/4") x (Height + 2 3/4")	(Width + 2 3/4") x (Height + 1 3/8")
All L Frames, IM	Width x Height	Width x Height
Deco Frame I	(Width + 3 1/2") x (Height + 3 1/2")	(Width + 3 1/2") x (Height + 1 3/4")
Deco Frame II or Modern Deco	(Width + 4 3/4") x (Height + 4 3/4")	(Width + 4 3/4") x (Height + 2 3/8")
Deco Frame III	(Width + 6 3/4") x (Height + 6 3/4")	(Width + 6 3/4") x (Height + 3 3/8")
Premium Faux Frames		
PVC Deco Z	(Width + 2 1/2") x (Height + 2 1/2")	(Width + 2 1/2") x (Height + 1 1/4")
PVC Matching Z	(Width + 3") x (Height + 3")	(Width + 3") x (Height + 1 1/2")
PVC Fancy Z or Large Single Bead Z	(Width + 3 1/2") x (Height + 3 1/2")	(Width + 3 1/2") x (Height + 1 3/4")
PVC Large Double Bead Z	(Width + 4") x (Height + 4")	(Width + 4") x (Height + 2")
PVC Beaded L, OM	(Width + 2 3/4") x (Height + 2 3/4")	(Width + 2 3/4") x (Height + 1 3/8")
PVC Beaded L, IM	Width x Height	Width x Height
PVC Small Deco	(Width + 4") x (Height + 4")	(Width + 4") x (Height + 2")
PVC Deco Frame I	(Width + 3 1/2") x (Height + 3 1/2")	(Width + 3 1/2") x (Height + 1 3/4")

FRAME PROFILES- WOOD SHUTTERS

L Frames

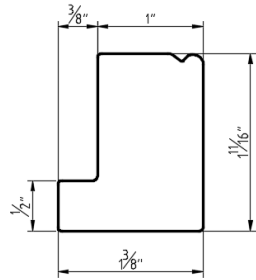

Beaded L

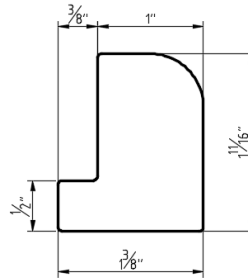

Bullnose L

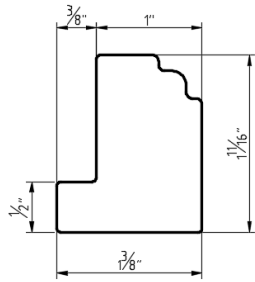

Colonial L

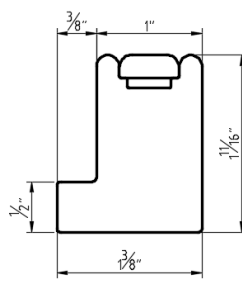

Vintage L

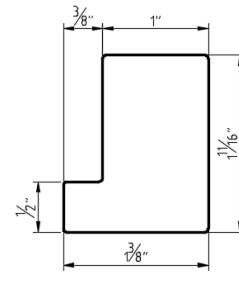

Shaker L

Deco Frames

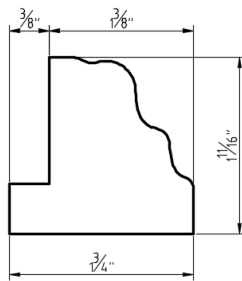

Deco I

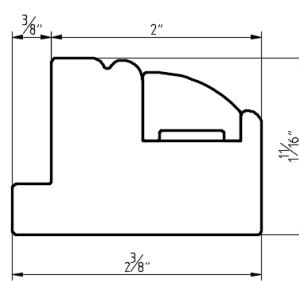

Modern Deco

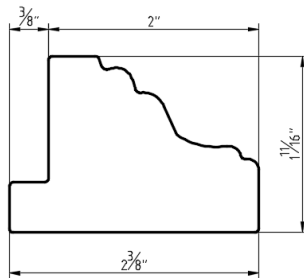

Deco II

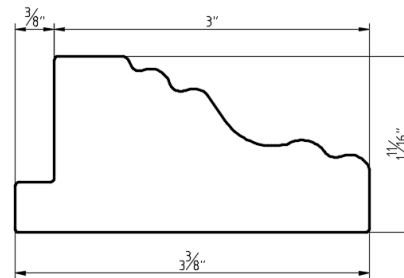

Deco III

Tilt Out Z Frames & Z Frames

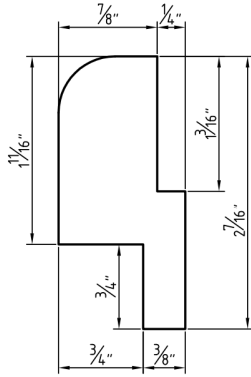

Bullnose Tiltout Z

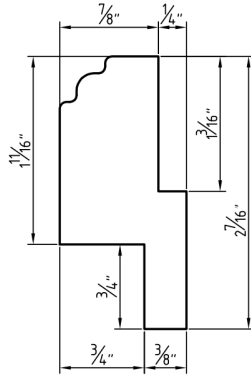

Colonial Tiltout Z

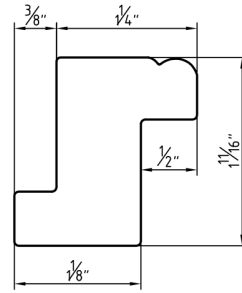

Beaded Z

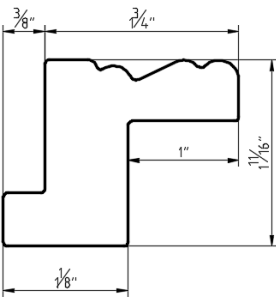

Deco Z

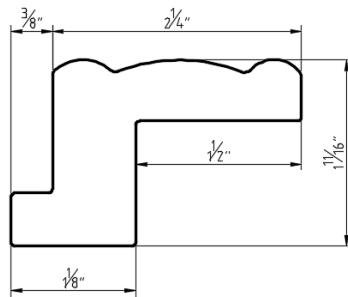

Medium Z

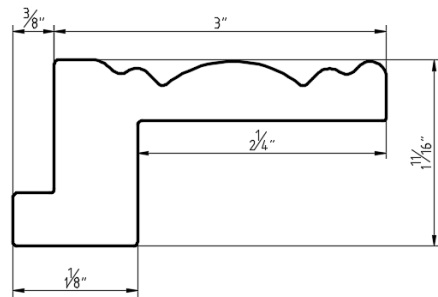

Large Crown Z

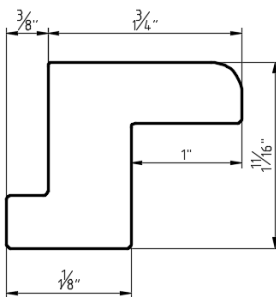

Bullnose Z

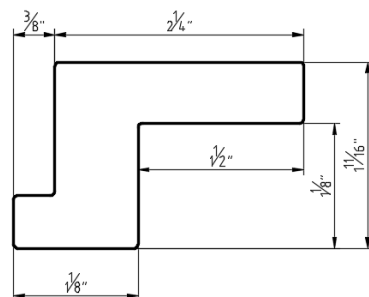

Shaker Z

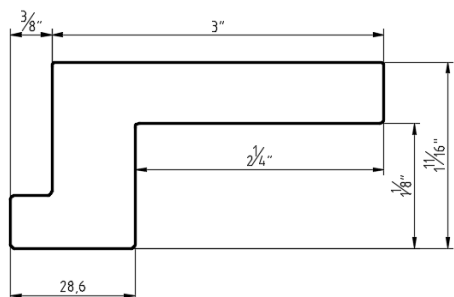

Large Shaker Z

Hang Strips

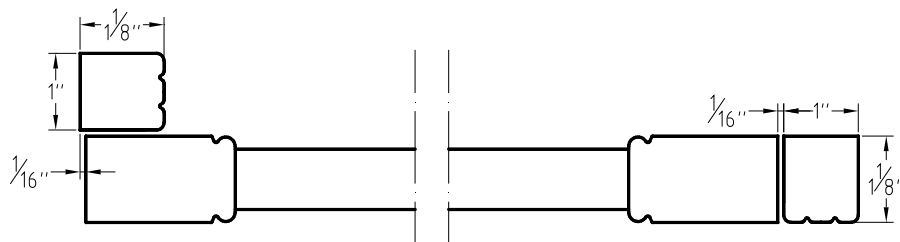

Hang Strip - Rear Mounted

Hang Strip - Side Mounted

FRAME PROFILES – PREMIUM FAUX

Frames

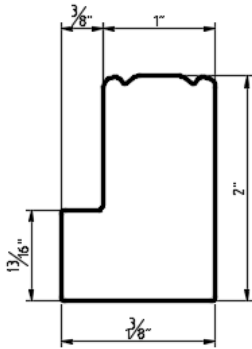

PVC - Beaded L

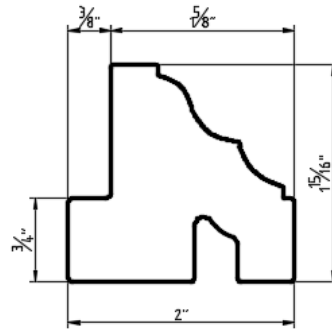

PVC - Small Deco

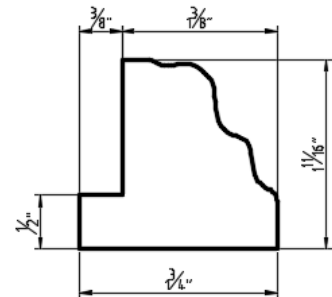

PVC - Deco I

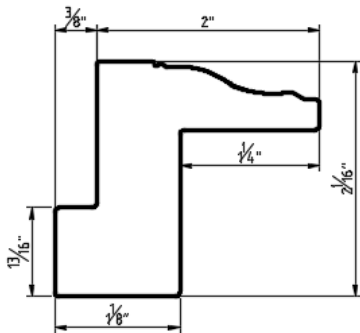

PVC - Deco Z

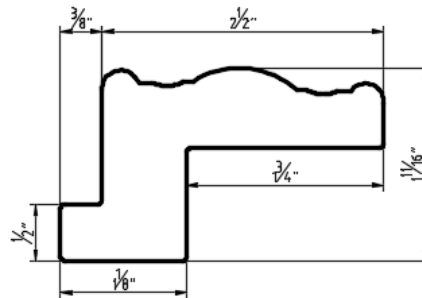

PVC - Fancy Z Frame

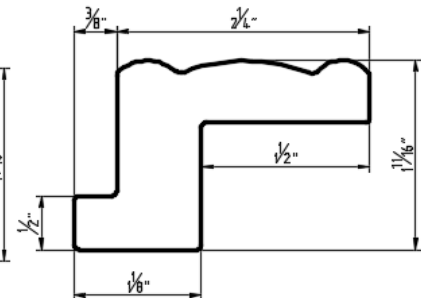

PVC - Matching Z Frame

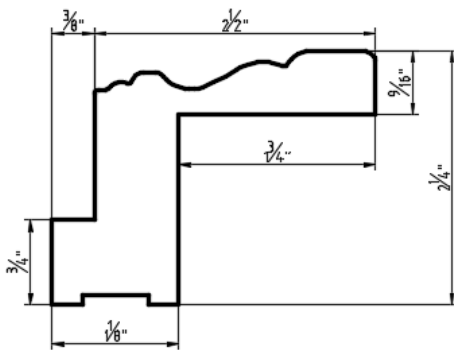

PVC - Large Single Bead Z

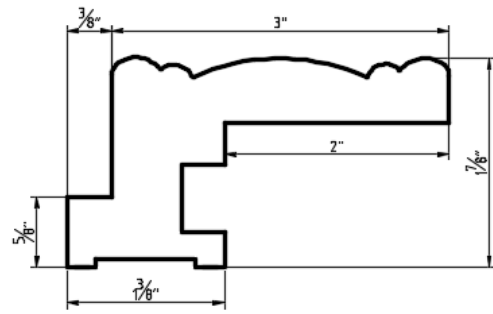

PVC - Large Double Bead Z

T-Post & Sill Frame

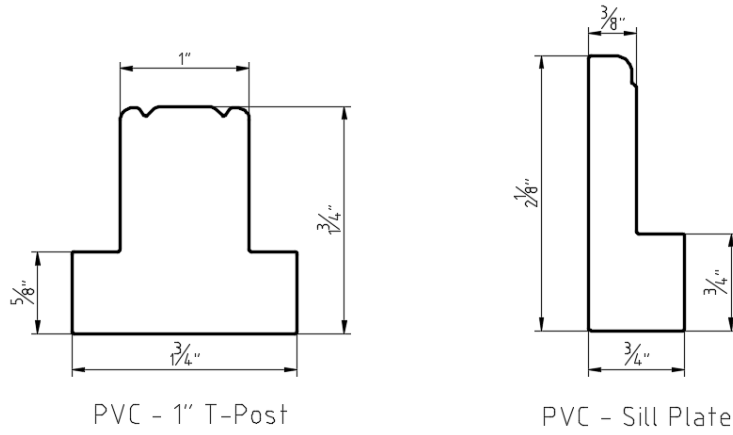

Louvers

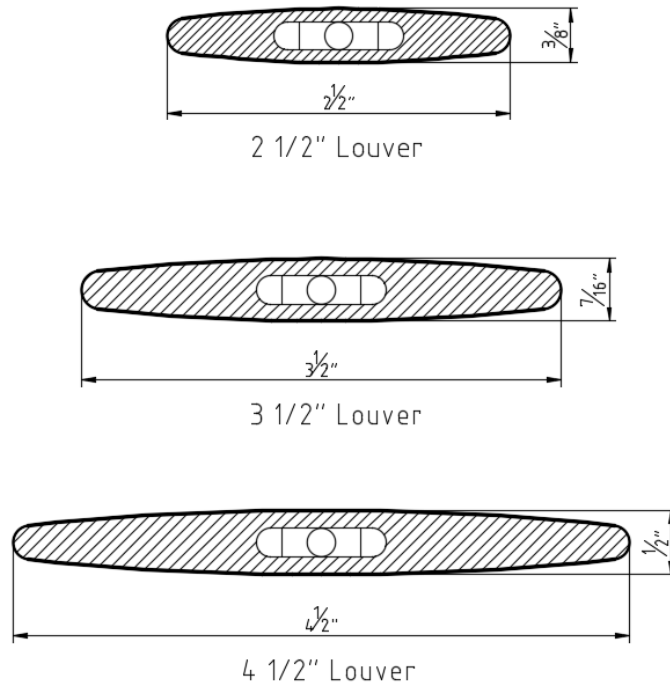

Stiles

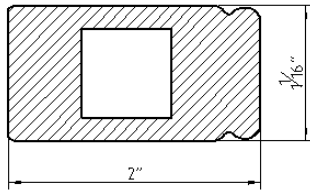

Butt Stile with Aluminum Insert

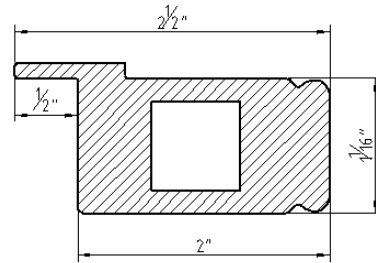

Astragal Stile with Aluminum Insert

Rails / Tilt Rod / Light Stop

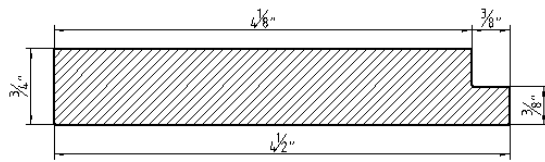

4 1/2" Top/Bottom Rail

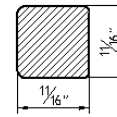

Light Stop

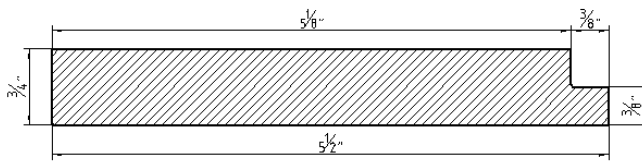

5 1/2" Top/Bottom Rail

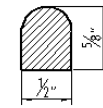

Tilt Rod

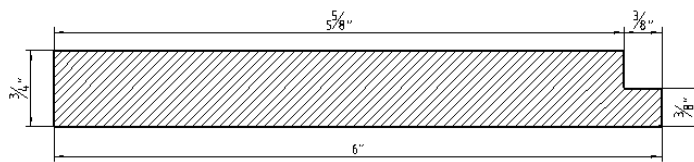

6" Top/Bottom Rail

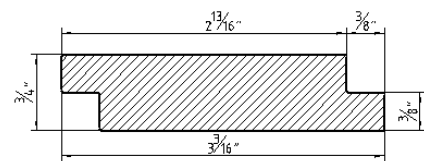

3" Divider Rail



WOOD SHUTTER SPECIFICATIONS

#	LindenTree	LindenTree Stain	LindenTree Premier Flat	Premium Faux	Sonora/Heartland Venicci/Chateau
Material	Hardwood	Hardwood	Hardwood	Poly	Hardwood
Standard Finish	19 Painted	15 Stained	19 Painted	19 Painted	(Page 15)
Custom Color	Yes	Yes	Yes	Yes	Yes
Louver Sizes	1.25",2.5",3.5", 4.5",5.5"	1.25",2.5",3.5", 4.5",5.5"	3" Flat & 4" Flat Only	2.5", 3.5",4.5"	1.25",2.5",3.5", 4.5",5.5"
Stile	Astragal, Rabbet	Astragal, Rabbet	Astragal, Rabbet	Astragal Only	Astragal, Rabbet
Standard T-Post	1", 2"	1", 2"	1", 2"	1" Only	1", 2"
Panel Width	Ideal Tilt: 8"- 36" Other Tilt: 8"-44"	Ideal Tilt: 8"- 36" Other Tilt: 8"-44"	8"-44"	8"- 36"	Ideal Tilt: 8"- 36" Other Tilt: 8"-44"
Surcharge for PNL Width Less than 12"	Yes	Yes	Yes	Yes	Yes
Max. PNL Width for Hinged Bi-fold	24"	24"	24"	20"	24"
Max. PNL Height	124"	124"	124"	124"	124"
DR Required @	74"	74"	74"	74"	74"
Stile/Rail Joints	Mortise & Tenon	Mortise & Tenon	Mortise & Tenon	Mortise & Tenon	Mortise & Tenon
Tilt Rod	STD, Offset, Hidden, Ideal	STD, Offset, Hidden, Ideal	Hidden	STD, Offset, Hidden	STD, Offset, Hidden, Ideal
Hinges	Non-Mortise, Hidden, Wrap Around Hinge	Non-Mortise, Hidden, Wrap Around Hinge	Non-Mortise, Hidden, Wrap Around Hinge	Non-Mortise, Wrap Around Hinge	Non-Mortise, Hidden, Wrap Around Hinge
Stile Type	Smooth, Beaded	Smooth, Beaded	Smooth, Beaded	Beaded Only	Smooth, Beaded
Arch at Top	Yes	Yes	Yes	Yes	Yes
French Door	Yes	Yes	Yes	Yes	Yes
Sliders	Yes	Yes	Yes	Yes	Yes
Corner/Bay	Yes	Yes	Yes	Yes	Yes
Double Hung	Yes	Yes	Yes	Yes	Yes
Raised PNL	Yes	Yes	Yes	Yes	Yes



<p>Frames</p>	<p>All L Frames Deco I/II/III Modern Deco Beaded Z Bull Nose Z/Deco Z Medium Z/Shaker Z Large Crown Z Large Shaker Z Tilt-out Z Frames</p>	<p>All L Frames Deco I/II/III Modern Deco Beaded Z Bull Nose Z/Deco Z Medium Z/Shaker Z Large Crown Z Large Shaker Z Tilt-out Z Frames</p>	<p>All L Frames Deco I/II/III Modern Deco Beaded Z Bull Nose Z/Deco Z Medium Z/Shaker Z Large Crown Z Large Shaker Z Tilt-out Z Frames</p>	<p>PVC Beaded L PVC Small Deco PVC Deco I PVC Deco Z PVC Fancy Z PVC Matching Z PVC Large Single Bead Z PVC Large Double Bead Z</p>	<p>All L Frames Deco I/II/III Modern Deco Beaded Z Bull Nose Z/Deco Z Medium Z/Shaker Z Large Crown Z Large Shaker Z Tilt-out Z Frames</p>
----------------------	--	--	--	---	--



STANDARD COLOR CHART

Series	Color	Recommend Hinge Color	LindenTree	LindenTree Stain	LindenTree Premier	Premium Faux	Heartland Rustic
19 Paints	003 Silk White	Snow White	X		X	X	
	006 Pearl	Swiss Coffee	X		X	X	
	009 Steamed	Swiss Coffee	X		X	X	
	063 Tailored	Snow White	X		X	X	
	000 Just White	Snow White	X		X	X	
	001 Clean White	Snow White	X		X	X	
	005 Elegant	Swiss Coffee	X		X	X	
	007 Off White	Swiss Coffee	X		X	X	
	010 Navajo	Swiss Coffee	X		X	X	
	011 Antique	Swiss Coffee	X		X	X	
	012 Cream	Swiss Coffee	X		X	X	
	016 Swiss Coffee	Swiss Coffee	X		X	X	
	022 Divine	Swiss Coffee	X		X	X	
	023 Dove White	Swiss Coffee	X		X	X	
	111 Pure White	Snow White	X		X	X	
	112 Alabaster	Swiss Coffee	X		X	X	
	114 Extra White	Snow White	X		X	X	
	116 Eider White	Swiss Coffee	X		X	X	
118 Repose Gray	Swiss Coffee	X		X	X		
15 Stains	247 Scout	Antique Brass		X			
	206 Pecan	Antique Brass		X			
	209 Fruitwood	Antique Brass		X			X
	212 Dark Teak	Antique Brass		X			X
	213 Black	Oil Bronze		X			X
	214 Brazil Nut	Antique Brass		X			X
	216 Rose	Antique Brass		X			
	218 Warm	Antique Brass		X			
	220 Mahogany	Antique Brass		X			
	221 Bright	Antique Brass		X			X
	226 Oak Mantel	Antique Brass		X			
	230 Light Brown	Antique Brass		X			X
	231 Aged Teak	Antique Brass		X			
	233 Coffee	Antique Brass		X			
	234 Burnt Toffee	Oil Bronze		X			



EXTENDED COLOR CHART

Series	Color	Recommend Hinge Color	Venicci	Chateau	Designer
Venicci #5	501 Bella	Antique Brass	X		
	502 Toscana	Antique Brass	X		
	503 Fiorenza	Antique Brass	X		
	504 Piazza	Antique Brass	X		
	505 Roma	Antique Brass	X		
	506 Ragazza	Antique Brass	X		
Chateau #6	601 Original Russet	Oil Bronze		X	
	602 Light Amber	Oil Bronze		X	
	603 Warmest Birch	Antique Brass		X	
	604 Mist	Oil Bronze		X	
	605 Brownish Tones	Oil Bronze		X	
	606 Dark Chocolate	Oil Bronze		X	
Designer #7	701 Quick Silver	Antique Brass			X
	702 Shadow	Antique Brass			X
	703 Ghost	Antique Brass			X
	704 Greige	Oil Bronze			X
	705 Warmest Grey	Oil Bronze			X
	706 Rich Brown	Oil Bronze			X
Custom	998 Custom Paint				
	999 Custom Stain		X	X	X

MEASURING GUIDELINGS

Measuring and installing Plantation Shutters can be easy. There are only a few simple tools needed and some carefully followed instruction.

Exus has assembled the information below to aid you in measuring of Exus Custom Shutters.

1. When measuring your window, you will need the following tools

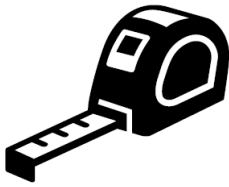

Steel Tape Measure

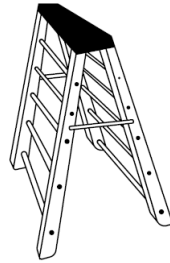

Step Stool



Order Form

2. Measure each window individually. Many windows look to be the same size, but can vary by a significant amount.
3. Label each window on the order form. Example: Living Room Left.....
4. For most applications, plantation shutters will be “framed”. This means that we will include a decorative frame that the shutter panels will be hinged to. This makes for a beautifully finished product and aids in the ease of installation.
5. Choose your frame type. This is typically an easy selection that you will make based on whether the shutters will be installed inside the window opening or on the surface of the wall or window molding on the outside of the window opening.
6. There are primarily three types of frames to choose:
 - Z Frame (exclusively for an inside mount application)
 - Deco Frame (exclusively for an outside mount application)
 - L Frame (either an inside or outside mount application)
7. If your window has no molding around it, an inside mount is preferable (Fig. A). This applies to windows with no molding, but do have a window sill at the bottom as well (Fig. B).



Fig. A. Window with no trim or molding

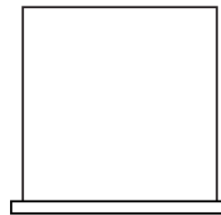

Fig. B. Window with no trim or molding but has window sill

8. If your window does have molding around it, an outside mount is preferable. (Fig. C)

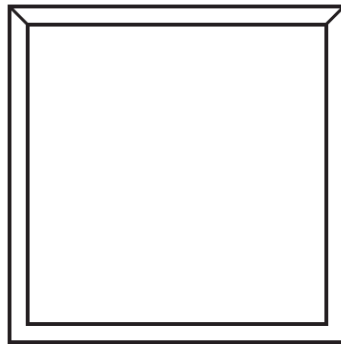

Fig. C. Window with molding trim

Window Size – Inside Mount Measuring(Used for Z frames, inside L frames)

Use this method when providing window size dimensions and you need us to make adequate deductions in order for the shutter to install inside the window opening.

9. Using a steel tape measure, measure the width of the inside of the window opening to the closest 1/8" in three places. Top, Center, Bottom. If you have selected an inside mount application, provide the narrowest of the three measurements on the measure form. We will take all necessary deductions in order for the shutter to fit into the window (Fig. D).
10. Using a steel tape measure, measure the height of the inside of the window opening to the closest 1/8" in three places. Left, Center, Right. If you have selected an inside mount application, provide the shortest height of the three measurements on the measure form. We will take all necessary deductions in order for the shutter to fit into the window (Fig. E).

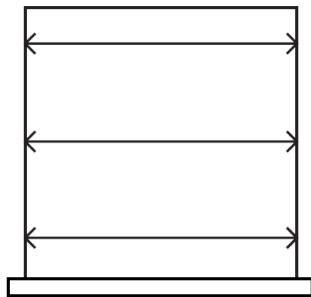

Fig. D

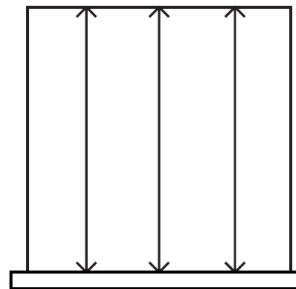

Fig. E

Window Size – Outside Mount Measuring (Used for Deco Frames and L frames)

Use this method when providing the window size dimensions and you need us to add an adequate amount for the shutter to install outside and around the window opening. We will make additions to your window size given.

11. Using a steel tape measure, measure the width of the inside of the window opening to the closest 1/8" in three places. Top, Center, Bottom. If you have selected an outside mount application, provide the widest of the three measurements on the measure form. We will make all necessary additions to the shutter so that it fits around the window opening (Fig. F).
12. Using a steel tape measure, measure the height of the inside of the window opening to the closest 1/8" in three places. Left, Center, Bottom. If you have selected an outside mount application, provide the tallest height of the three measurements on the measure form. We will make all necessary additions to the shutter so that it fits around the window opening (Fig. G).

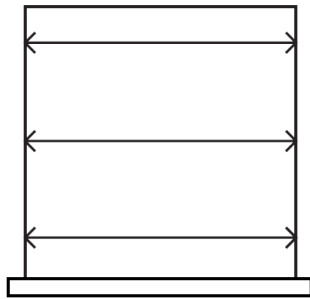

Fig. F

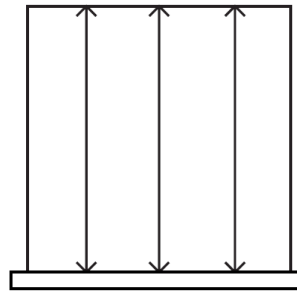

Fig. G

Frame to Frame Measuring (Used for deco Frames and L frames)

Use this method when providing the finished size you wish the shutter to be. We will make no additions or subtractions to the sizes given.

13. In some instances, it may be beneficial for the measurement given on an inside or outside mount shutter to be the exact measurement of the finished shutter. It is commonly called “tip to tip” measuring as the finished dimension of the frame will be exactly what is requested. In this instance, we will make no additions, nor take any deductions from the measurements given. This will be specified on the measure form as “F” meaning frame to frame. Frame to frame measurements can be useful in inside or outside mount shutter when there is an exact spot that the shutter frame must align with (Fig. H).

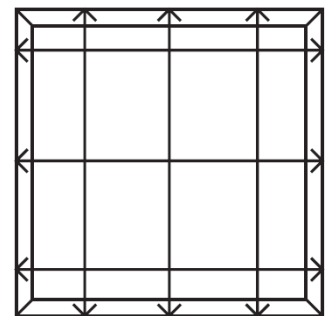

Fig. H

Hint: Provide Exact Finished Size of Shutter Required

Number of Frame Sides

14. Determining the number of sides that frame is needed on is easy. Generally speaking:

- If the window has a window sill, the number of sides is three sides (3). We recommend using a sill frame that will rest on the window sill and will aid in the installation process. For this application, the shutter will be ordered as a 3SP. We will build the shutter framing with the left, top, and right with shutter framing. The bottom piece will be a simple piece designed specifically to rest on the existing window sill (Fig. I).
- If the window has no window sill, the number of sides is four sides (4). We will provide the framing on the left, top, right, and bottom of the shutter (Fig. J).

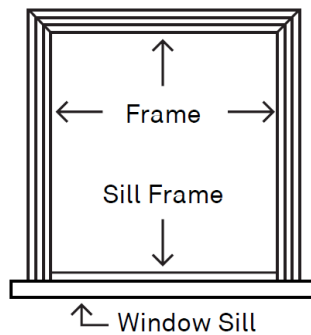

Fig. I. Window with sill

3 sides of frame with sill frame at bottom

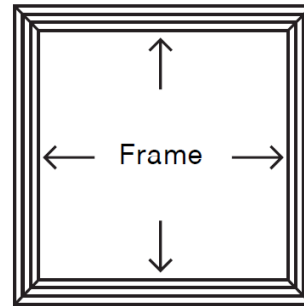

Fig. J. No window sill

4 sides of frame

Panel Configuration

15. Panel configuration is only asking which side the shutter the hinges will be attached to. For windows 36" wide or narrower, it is possible to hinge single panel shutters on the left or right side (Fig. K). For windows wider than 36", two or more panels are required. The configuration for two panels is LR meaning one panel hinges left, one panel hinges right (Fig. L).

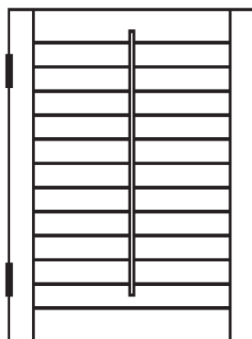

Fig. K. 1 Panel Hinge Left

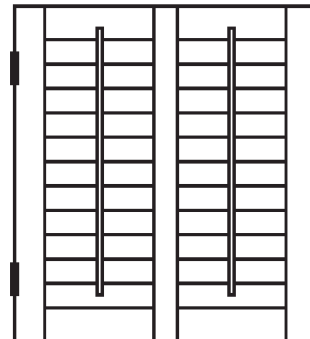

Fig. L. 2 Panels L/R

T-Post Location(s)

16. For windows wider than 72" that require more than two shutter panels, we recommend using a T-Post, or Multiple T-Posts. A T-post is a vertical piece of shutter material that is used to hinge the shutter panels to if there are more than two shutter panels required. Frequently these wide windows will have mullions that separate the actual windows. This is the ideal location to utilize a T-Post (Fig. M).

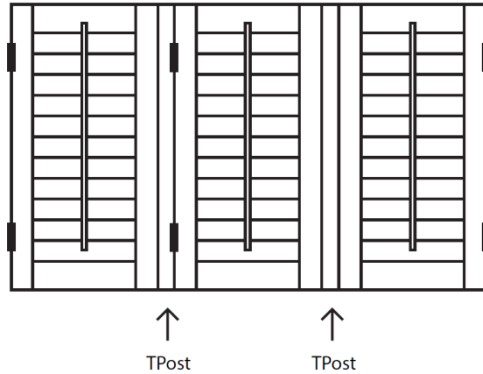

Fig. M

- Measure from the left side of the **window opening** to the center of each mullion for each shutter that is being ordered as Window Size - Inside Mount or Window Size - Outside Mount. This will be the T-Post location(s). Once this is determined, the panel configuration for each panel can be chosen. Example: LTLTR. Panel hinged on the left, the left, and the right (Fig. N).

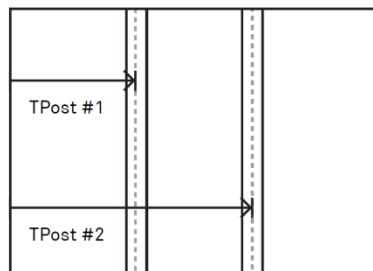

Fig. N

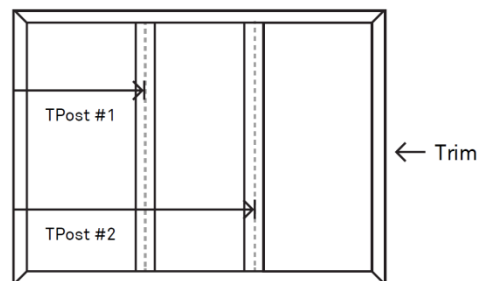

Fig. O

- Measure from the left side of the **frame location** to the center of each mullion for each shutter that is being ordered as Frame to Frame dimensions. This will be the T-Post location(s) once this is determined, the panel configuration can be chosen. Example: LTLTR. Panels hinged on the left, the left, and the right (Fig. O).

Divider Rails

17. For windows that measure taller than 74" in height, a divider rail is required. For windows under 74" tall, a divider rail is optional. The divider rail is a horizontal piece of shutter material that is incorporated into the shutter panel. It separates the opening of the louvers between a top section and a bottom section of louvers. If the window has a window sash, it is recommended that the measurement for the divider rail is at the sash location. For all inside or outside mount shutters, measure from the bottom of the window to the center of the window sash to determine this location (Fig. P). For shutters being ordered as Frame to Frame, measure from the bottom of the frame location to the center of the window sash for this location (Fig. Q). If there is no window sash, the divider rail can be ordered as "centered" or at any location that is logical.

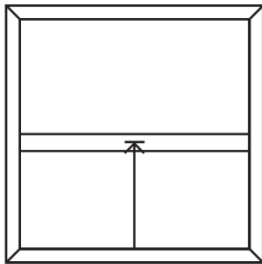

Fig. P. Inside or outside mount measuring

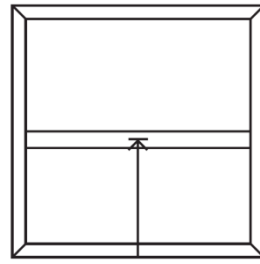

Fig. Q. Frame to frame measuring

Special Shapes (Arched Windows, Curved Window, Eyebrow Windows)

18. All of the above information regarding measuring of rectangular windows applies to the proper measurements for special shaped windows, but there is one additional step required.

- When measuring for a special shape window, first measure the width and tallest height using the guidelines for rectangular windows above (Fig. R). The next measurement that is needed is what is referred to as the "leg height". This "leg height" is the dimension of the height from the bottom of the window or the bottom of the shutter frame (see above) to the point at which the curve portion of the window begins. This dimension is needed for the left and right of the window and is called the "leg height" (Fig. S).

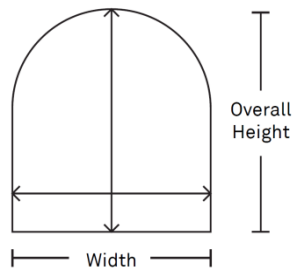

Fig. R. Inside or outside mount

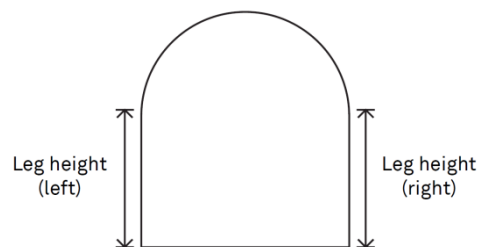

Fig. S. Frame to frame mount



Options

There are many options such as color, louver size, hidden or center tilt, hinge color, etc... These options are exclusively at your discretion and will not pertain to the measurements of shutters. Many sections of this manual address and explain the various options.

This concludes the basic measuring information and instructions. Our team of customer service professionals is available to assist with any questions you may have.



MISCELLANEOUS MEASURE INFORMATION

Exus requests you indicate the measurement type and the mount type. This designation is either W (Window Size) or F (Frame to Frame Size) for the measurement type and I or O for the mount type.

Window Size - Inside Mount

Factory makes appropriate deductions based on the ordered size:

- Standard deduction is ¼" on ordered width and height for all 3SP and 4 sided frames.
- Standard deduction is ¼" width and 1/8" height for all 3 sided frames with light stop at bottom
- Standard deduction is 3/16" on ordered width and height for all direct mount and hang strip shutters
- Standard deduction is ¼" width and ¼" deduction on height for all 2 sided frames with sill frame top and bottom.

Window Size – Outside Mount

Factory makes appropriate additions based on the ordered size:

- Standard addition to window size given will equal the size of the frame chosen for each side.
- The inside lip of the frame measurement will equal the ordered width and height.

Frame to Frame Size

The maximum outside measurements of the frame will equal the ordered width and height withno deductions or additions by the factory.

MEASURING WITH SPECIAL WALL CONDITIONS

Consider the maximum frame to frame size when measuring for special wall conditions.

For inside mount, measure the flat surface on the side.

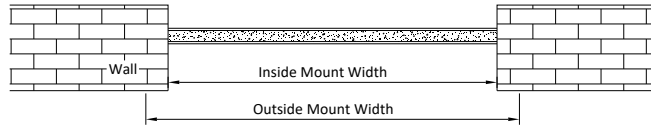

For outside mount, measure the flat surface on the wall.

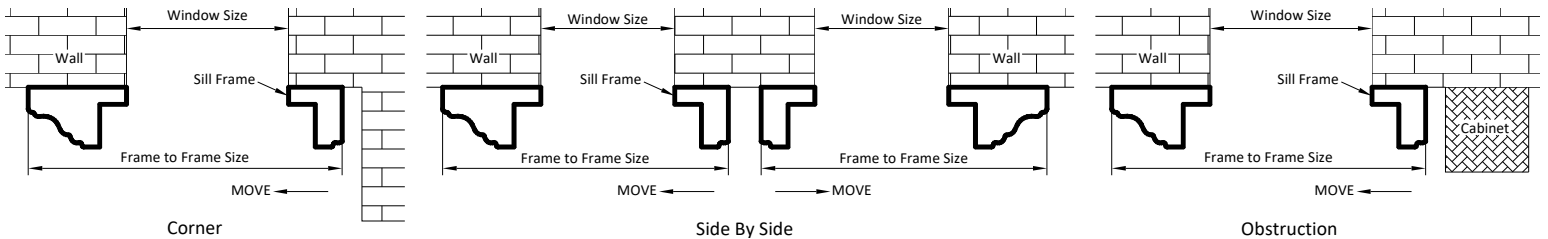
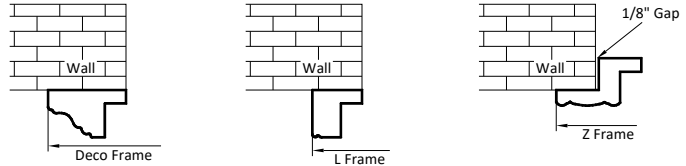

For special wall conditions, provide the measurement of the specific obstacle and select the appropriate frame style and mounting option based on these constraints.

MOUNTING OPTIONS

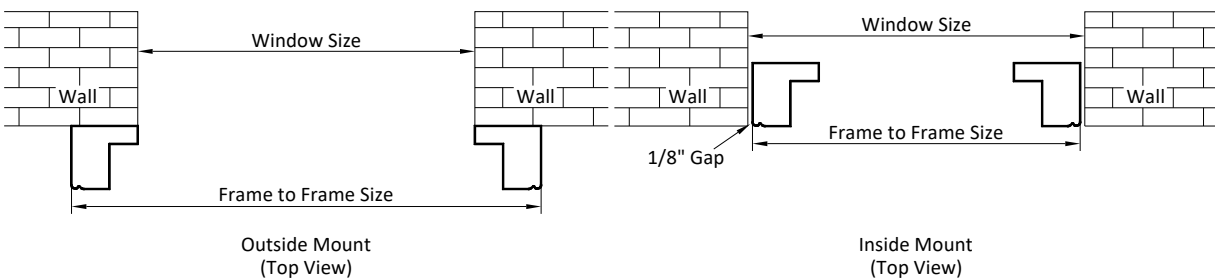

Outside mount: the shutter is mounted outside of the window opening

Inside mount: the shutter is mounted inside of the window opening

DIRECT MOUNT

Four light blocks are provided.

Two methods of measurement:

1. Window size: Measure the width and height of the window opening. And factory will take appropriate 3/16" deductions on both width and height of panel(s).
2. Maximum frame to frame size: Measure the maximum frame to frame width and height. Factory takes no deduction on width or height of panel(s). Customer will need to make their own hinge deduction.

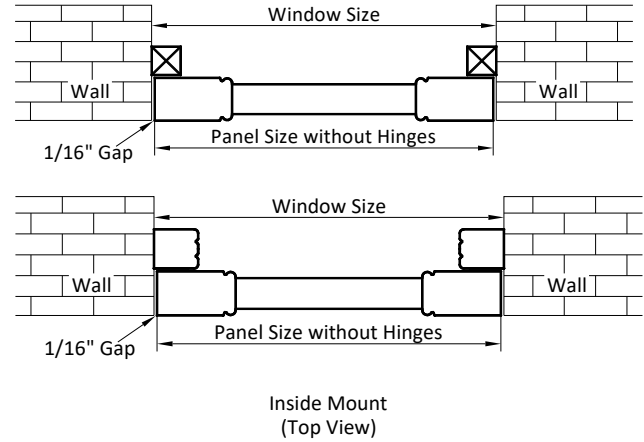

Design Idea

To the right is a Large Crown Z Frame with a T Post in the middle. As you can see the shutter is ordered as a three sided frame with a sill frame at the bottom allowing it to float above the granite sill. Placing the T Post in the middle RTL, allows both panels to almost fully open to avoid the faucet. This design is a much cleaner look than a LLRR and the customer doesn't have 8" of additional stiles in the window. There is also buildout placed behind the flange to compensate for the granite depth.



PARTS OF EXUS SHUTTERS (some are optional)

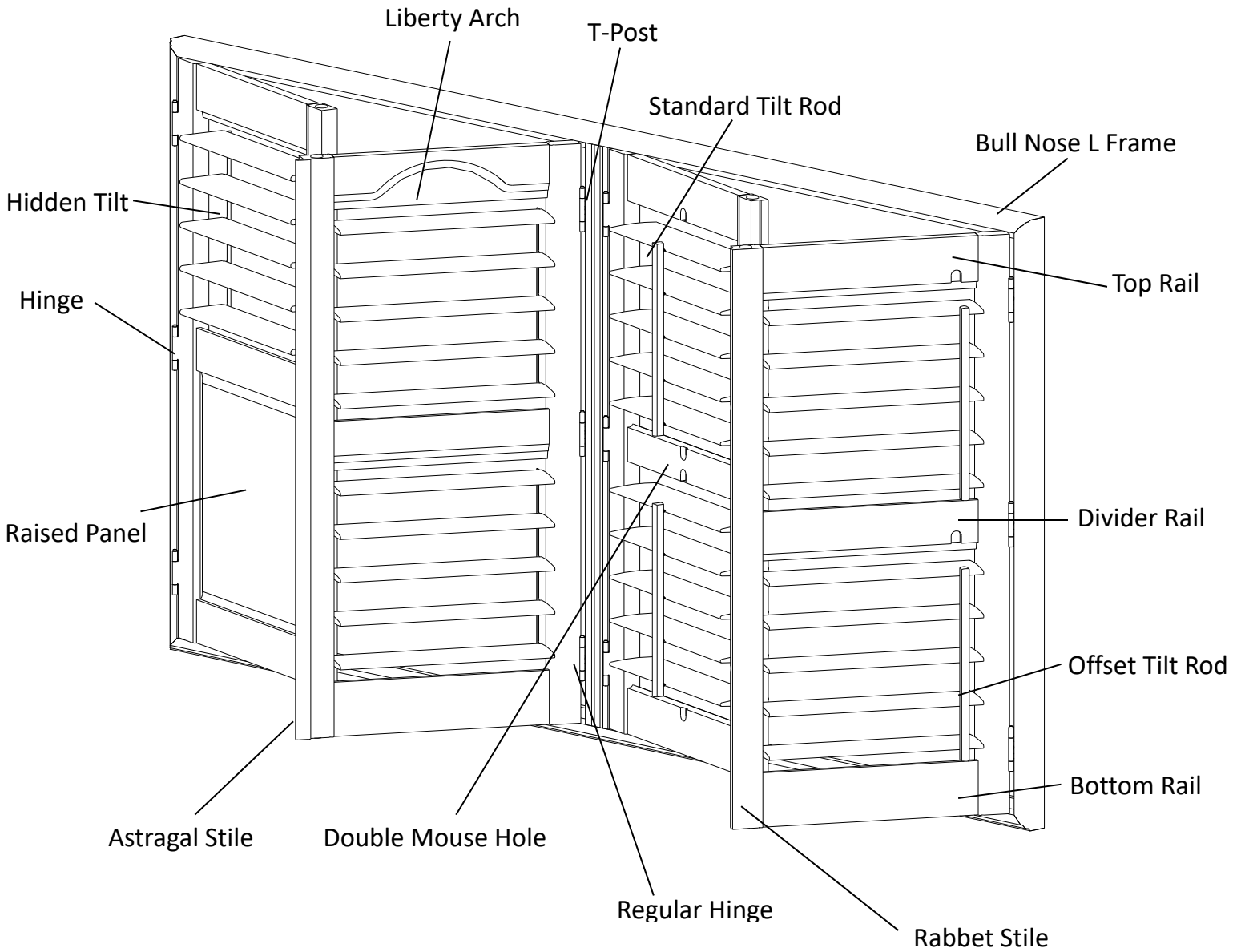

PARTS OF PANEL

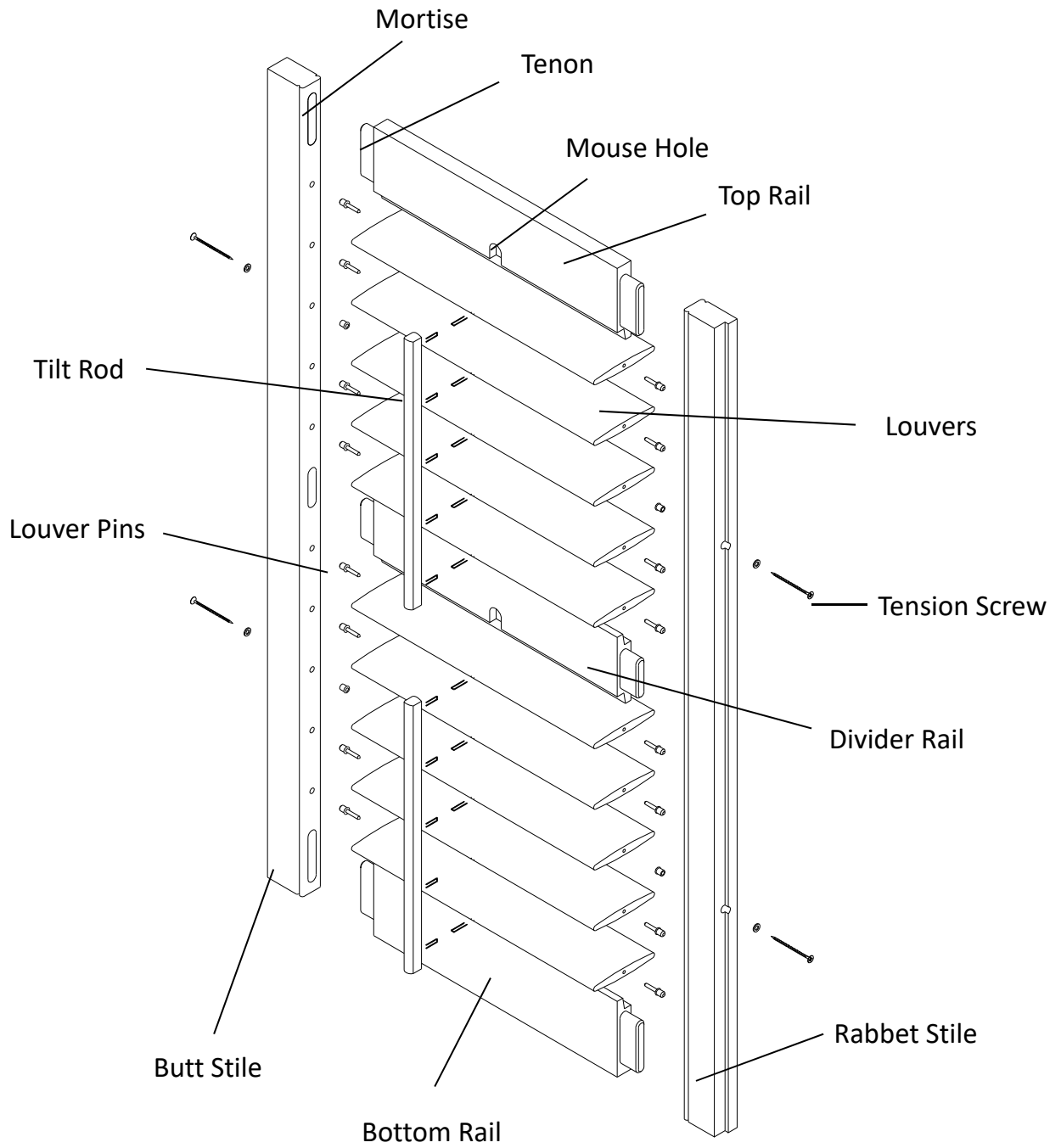

LOUVERS

Elliptical Louver Dimension

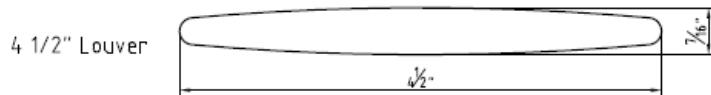
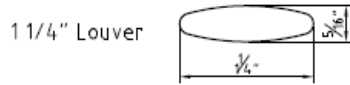

Flat Louver Dimension

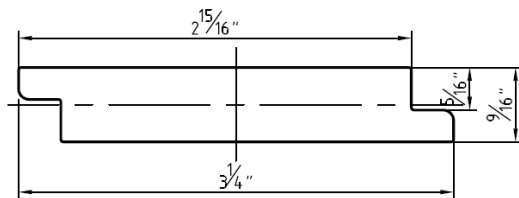

3" Flat Louver

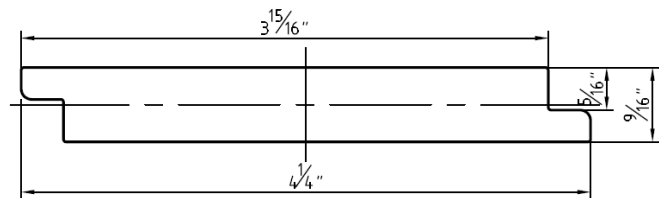

4" Flat Louver

*Flat Louvers are only available for LindenTree Premium Flat Product.

LOUVER MINIMUM CLEARANCE

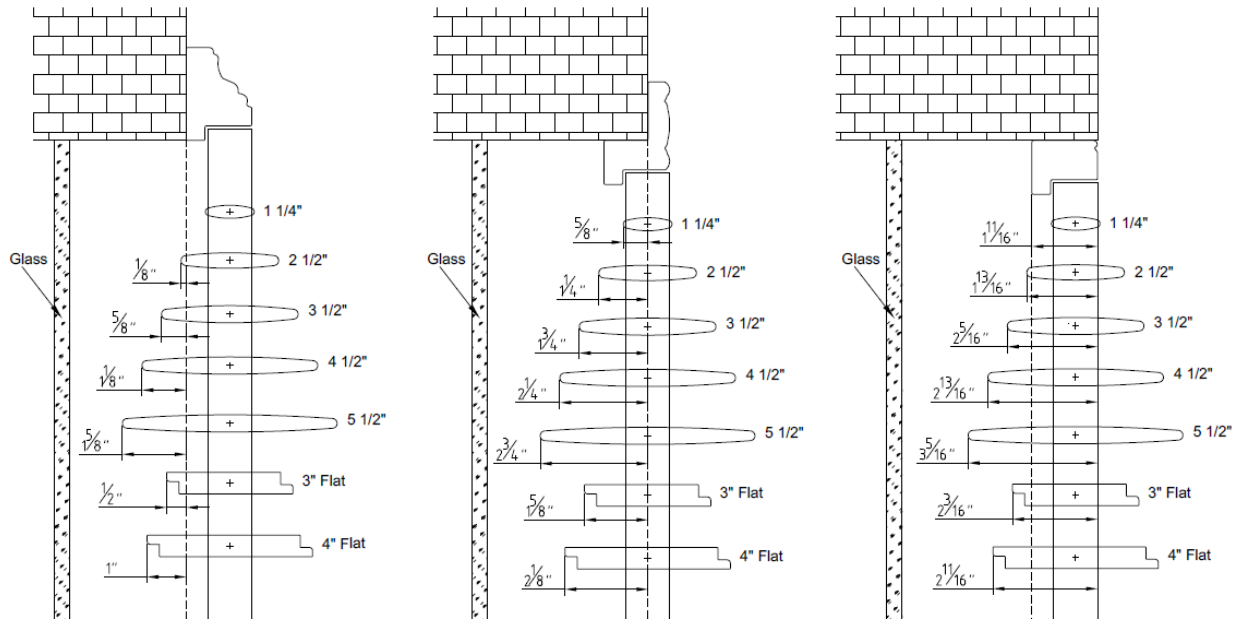

Once the mounting method is selected, choose the appropriate louver size taking into consideration the limitations of the window depth. If you use a frame extension or build out for an outside mount frame you will increase the louver clearance space.

Louver Minimum Clearance Chart (Outside Mount) Valid for All Standard & Hidden Tilt Rod

Frame Selection	Overlap Wall	1 ¼" Louver	2 ½" Louver	3 ½" Louver	4 ½" Louver	5 ½" Louver	3" Flat Louver	4" Flat Louver
Deco I	1 3/4"	0	3/8"	7/8"	1 3/8"	1 7/8"	3/4"	1 1/4"
Deco II	2 3/8"	0	3/8"	7/8"	1 3/8"	1 7/8"	3/4"	1 1/4"
Deco III	3 3/8"	0	3/8"	7/8"	1 3/8"	1 7/8"	3/4"	1 1/4"
L Frames (OM)	1 3/8"	0	3/8"	7/8"	1 3/8"	1 7/8"	3/4"	1 1/4"
PVC-Small Deco	2"	0	3/8"	7/8"	1 3/8"	1 7/8"	3/4"	1 1/4"

Louver Minimum Clearance Chart (Inside Mount)

Frame Selection	Overlap Wall	1 ¼" Louver	2 ½" Louver	3 ½" Louver	4 ½" Louver	5 ½" Louver	3" Flat Louver	4" Flat Louver
Beaded Z	1/2"	7/8"	1 1/2"	2"	2 1/2"	3"	1 7/8"	2 3/8"
Bull Nose Z	1"	7/8"	1 1/2"	2"	2 1/2"	3"	1 7/8"	2 3/8"
Deco Z	1"	7/8"	1 1/2"	2"	2 1/2"	3"	1 7/8"	2 3/8"
Medium Z/Shaker Z	1 1/2"	7/8"	1 1/2"	2"	2 1/2"	3"	1 7/8"	2 3/8"
Large Z/Large Shaker Z	2 1/4"	7/8"	1 1/2"	2"	2 1/2"	3"	1 7/8"	2 3/8"
L Frames (IM)	0	1 3/4"	2 1/8"	2 7/8"	3 1/8"	3 5/8"	2 1/2"	3"

FRAME SIEDS

2 Sided

Hang strip with inside mount is available only in 2-sided frame (Vertical). We will provide the light stop at no charge for hang strip with inside mount.

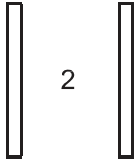

2 Sided with Sill Top

Light Stop included at no charge.

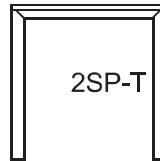

2 Sided with Sill Top and Bottom



3 Sided with Sill Bottom

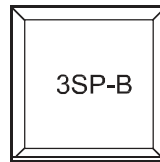

2SP-LR

3SP-L

3SP-R

3 Sided

Light Stop included at no charge.

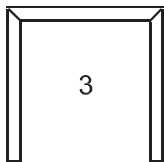

3 Sided will Sill Top

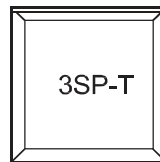

3 Sided Inverted

Light Stop included at no charge.

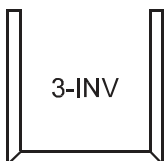

4 Sided

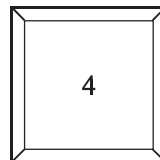

DETERMINE THE RIGHT LOUVER SIZE

Choosing the Right Louver Size

Generally, the choice of the size of louvers is based on at least one of the following factors:

- The preference of privacy versus visibility
- The interior design of the surrounding
- The size of the opening
- The depth of the opening

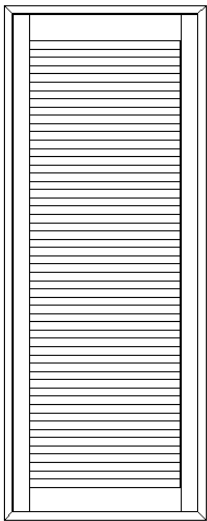

1 1/4" Louver

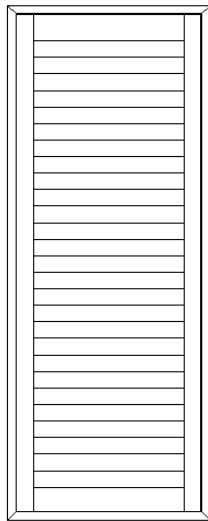

2 1/2" Louver

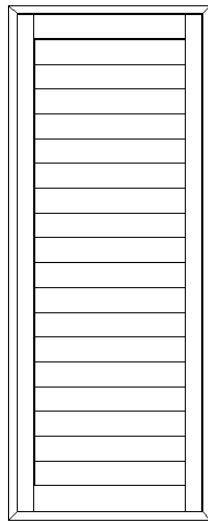

3 1/2" Louver

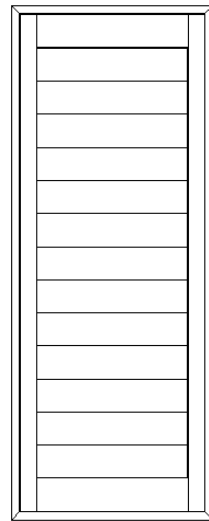

4 1/2" Louver

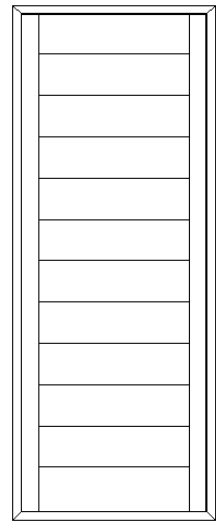

5 1/2" Louver

FRAME FLANGE

The picture to the right shows a flange (Dark area of frame). It is the part of the Z frame that overlaps the wall. The flange only relates to Z frames.

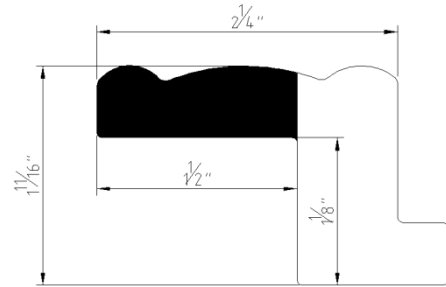

BUILD OUT

Build outs are used for mostly three functions.

- 1) To grow an L frame a safe distance away from an obstacle (window, lock, crank, etc.) so the louvers can rotate freely.

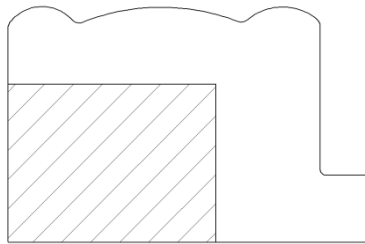

- 2) To make a Z frame act like an L frame.

Simply instruct Exus to provide build out for the back of the Z frame, and we will provide the result picture above. Simply nail or screw the build out to the back of the frame and install it like any L frame.

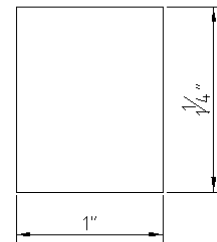
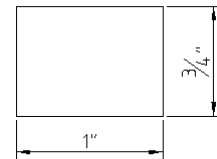

- 3) Using build out for fillers. You may have an issue where a customer has a sink with a soap dispenser, and the panels will not clear. You may choose to place a build out underneath the chosen frame lifting up the frame enough to clear this obstacle. You may also have a granite back splash of fancy tile that interferes with the frame sitting flush on the wall. Simply measure the thickness of the granite or tile and grow that portion of the wall the same thickness of the tile. Mount this build out first and then the shutter will sit flat and secure right on top of it.

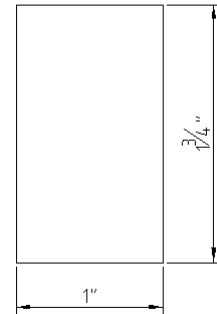

Build out can be custom made to meet any requirement needed.

Build out designation on our CAD drawing is a block with an X.

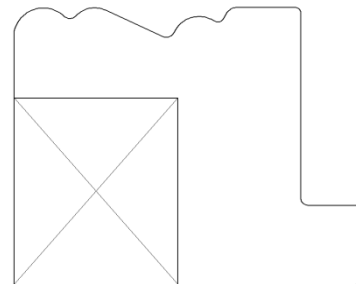

HOFFMAN KEYS

The wood working industry currently uses Hoffman Keys to easily join pieces of material together. We have adopted this practice with our shutters to allow installers to quickly assemble frames.

The keys are pre-installed, and for larger frames you may have two Hoffman Keys to reduce any gaps at the mitered joints.

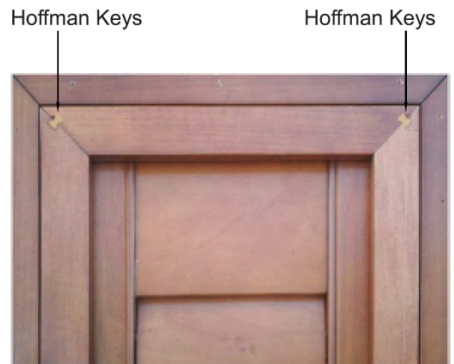

BUILD OUT EXAMPLE

The picture to the right side shows build out ordered to go behind a Deco Z frame to change a Z frame to an L frame. The customer wanted to keep the frame consistent throughout the house.

Even though this is the back of the frame, you can see the gap between the build out and the frame. This is similar look when you join two pieces of wood together.

If you want to eliminate the gap and the trouble of the joining two pieces of wood together, then a frame extension is your solution.



FRAME EXTENSION

A frame extension is almost the same as a build out except that it is attached to the frame.

The pictures to the right illustrate an L frame with an extension. This frame extension is providing the necessary clearance for an outside mount using 3 1/2" louvers to clear the drywall.

Frame extension designation on our CAD drawing is a block without an X, but rather an empty box next to a frame.



STILES

Rabbet Stile

A rabbet stile is an overlap of the stile that reduces light penetration. We use rabbet type stiles when two stiles meet together. The hinge side of the panel will always have a flat stile. The normal configuration is for the right side to overlap the left side. Therefore, a reverse rabbet is to have the left side open before the right side.

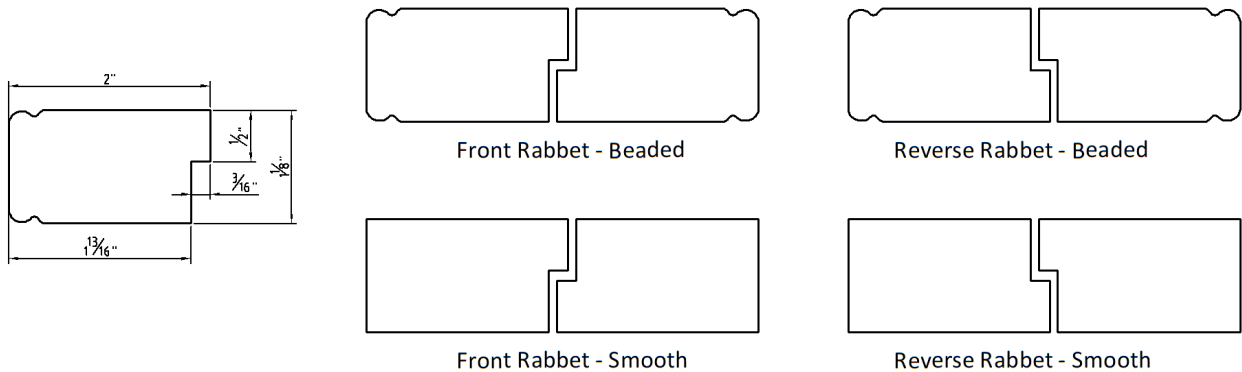

Astragal Stile

Exus offers astragals for a clean look that provides light block.

Installers love this because sometimes when you have to tweak a frame no one will see the gap when dealing with out-of-square windows.

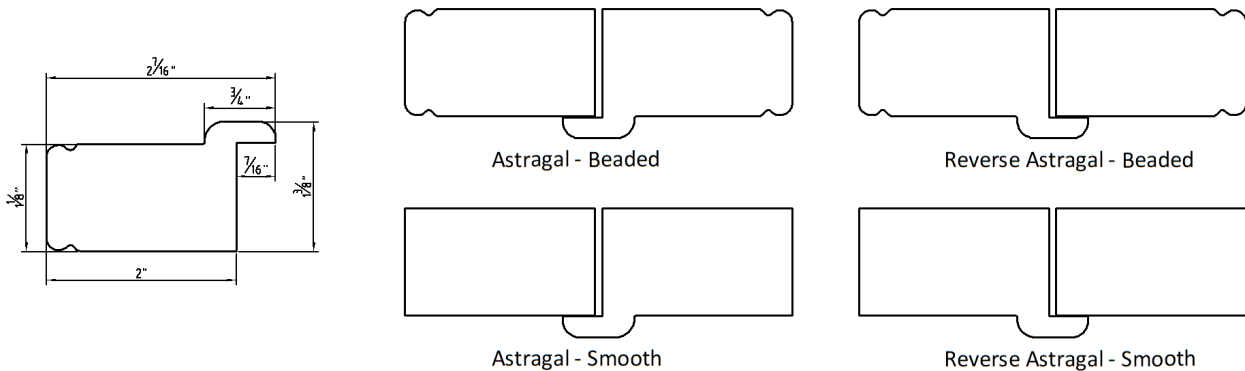

Butt Stile

Exus uses a 2" stile for our shutters. Example to the right is a flat butt stile.

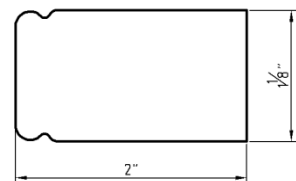

MOUSE HOLES / DOUBLE MOUSE HOLES

A mouse hole on the rail above and below each louver section allows the louvers to be rotated either upward or downward. Our shutters come standard with one mouse hole on the top rail, and close in the “UP” position.

It may be necessary to explain to your customers that if they don’t choose a double mouse hole, the louvers will not close completely in the down position. Please note that all arch top shutters will only close in the up position. Attempting to close the arched louvers in the down position will cause non-warranty damage to the top louver, or louver pin.

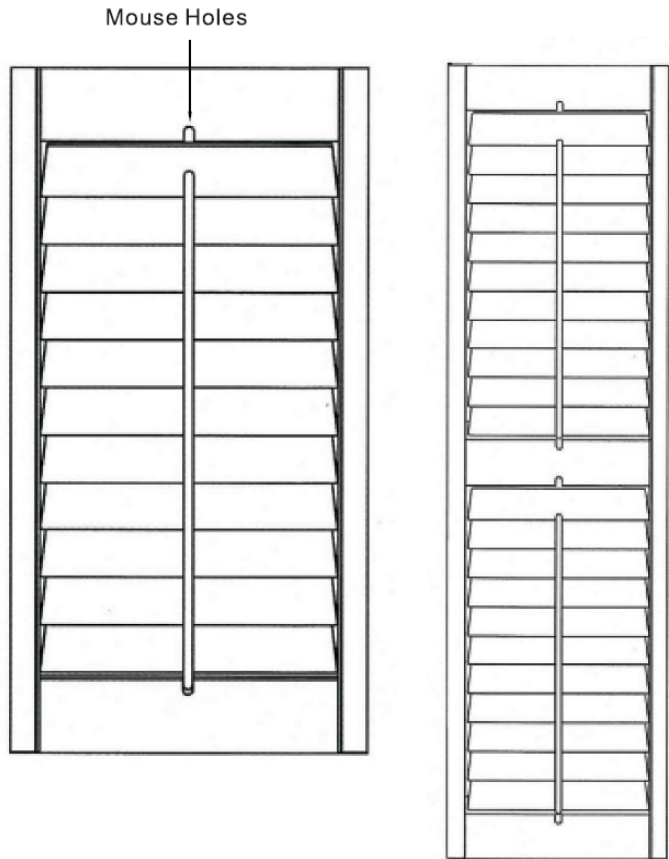

LIBERTY ARCH

Liberty Arches are a decorative way to design the top rail in lieu of a mouse hole.

Liberty Arches will be standard with our Chateau line. However, minimum panel width for Liberty Arch is 10”.



TILT RODS

Standard Tilt Rod

The standard 1/2" wide tilt rod is usually located in the center of the panel. It normally relates to having a mouse hole on the top rail allowing it to rest inside. The purpose of a tilt rod is to keep the synchronization of the louvers. However, we always suggest opening and closing the louvers by tilting the louvers themselves by hand to avoid separating the staple from the tilt rod of the louver.

The tilt rod may be split at almost any position desired. This provides the same functionality (not stability) of a divider rail and usually looks nicer.



Offset Tilt Rod

The tilt rod may be positioned to left or right (offset) of the center. As default it is placed 1" from the edge of the louvers, offset to the oppositeside of hinges. All offset tilt rods come standard with one mouse hole.

It is sometimes preferable to offset the tilt rod for arch top panels towards the tallest point allowing more of the louvers to rotate.



Hidden Tilt Rod

Hidden tilt rods are either white or dark brown aluminum that connects to the back of the panel on the sided of the louver. The hidden tilt rod may also be cut almost anywhere in lieu of a divider rail, but the hidden tilt rod has to be cut every 39". If Hidden tilt rod is split into 2 pieces and the number of louvers is uneven, more louvers will be attached to the bottom tilt rod than the top. Custom paint colors can have the tilt rod painted to match. However, this process doesn't carry the limited lifetime warranty since it is not powder coated. Custom stain colors have one dark brown hidden tilt bar.



Hidden Tilt Rod is available for 2 1/2", 3 1/2", 4 1/2" and 5 1/2" louvers.

Ideal Tilt Rod

Ideal Tilt is an internal gear system built into the stile to operate the tilting of the louvers without any tilt bar. This is real clearview tilt rod shutter. The maximum louver quantity attached to Ideal Tilt Rod will be as per the right chart, and if the louver quantity exceeds this limit the Ideal Tilt Rod will be split automatically into two pieces.

Louver Size	Maximum Louver Qty
2 1/2"	14
3 1/2"	14
4 1/2"	10
5 1/2"	5

HINGES / COLORS

Similar to door hinges, shutter hinges attach the panel to the frame or T-Post allowing the panel to be opened or closed. This allows for a 180 rotation if there are no obstructions. Our standard hinges are self-mortising do to its design to minimize gaps.

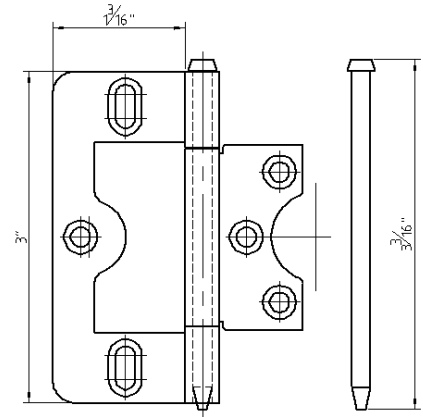
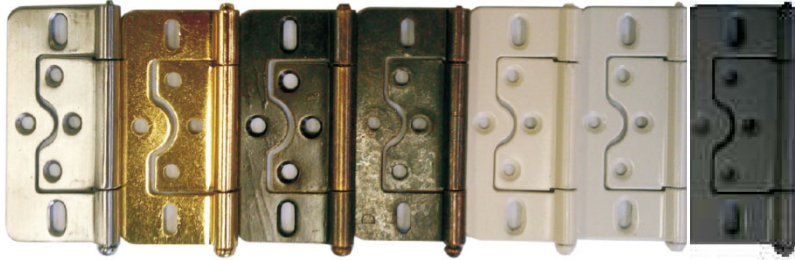

*From Left: Stainless Steel, Bright Brass, Oil Rubbed Bronze, Antique Brass, Swiss Coffee, Snow White, and Black

HIDDEN HINGES / COLORS

Hidden hinges have the same max/min requirements as regular hinges. They open 180 and instead of a hinge pin to secure them you are provided a set screw. These screws must be placed in the pre-drilled hole to ensure the panel does not fall out of the frame.

The current color available is silver.

Following frames are unavailable in Hidden Hinges.

Vintage L, Colonial L, Modern Deco, Deco II, Bull Nose Tilt-out Z and Colonial Tilt-out Z.



WRAP AROUND HINGES

The wrap around hinge is used exclusively for shutters that use an inside mount hang strip where the hang strip is placed behind the panel.

Stainless Steel is not available for wrap around hinges.

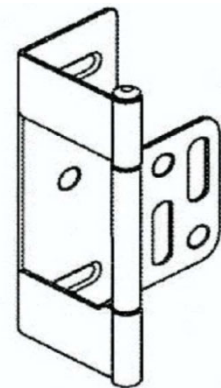

DIVIDER RAIL / PLACEMENT

Divider rails are used to divide the panel horizontally into two sections and add stability to the overall structure of the shutter. This enhances the appearance of the shutters and enables better light control as each section is adjusted independently.

Divider rail can also be used to cover existing rails in the window opening ensuring a continuous look for the window.

Divider rail size will be approximately matched with louver size. However, we can make divider rails larger than the chosen louver size for a surcharge.

From a construction standpoint, divider rails are recommended for panels over 74" height. Exus defaults the divider rail placement to the center of the opening. However, this placement varies depending on the louver size. If an exact placement is required, please provide the distance from the bottom of the shutter to the center of the divider rail. This may cause a variance in the top and bottom rail sizes.

For 2 1/2" louver shutter, the size of divider rail is 4 1/2". Because 2 1/2" divider rail is too small and tenon on the rail is smaller even that it doesn't help for the structural strength of the large panel.

Louver Size	Divider Rail	Allowable Float
2 1/2" Louvers	4 1/2"	±1"
3 1/2" Louvers	3 1/2"	±1 1/2"
4 1/2" Louvers	4 1/2"	±2"
5 1/2" Louvers	5 1/2"	±2 1/2"



Divider rail allowable float

TOP AND BOTTOM RAILS

Top and bottom rails vary in size depending on the height of the shutter and the louver size selected. 6 1/2" is our maximum rail height.

Please note: The rails are the only dynamic part on the shutter. 1/8" difference from opening to opening may mean one extra or one less louver. When possible, always choose the same height for all windows side by side or in the same room.

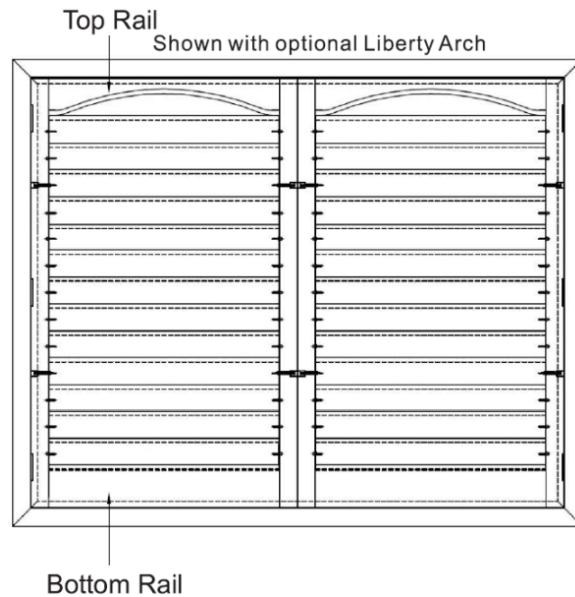

Top and Bottom Rail Range

Panel Height Range	Louver	Top/Bottom Rail Range	Note
H < 48"	1 1/4" Louver	3" – 3 1/2"	The ranges are only for single windows with no exact divider rail. If windows are side by side or exact divider rails requested, the top/bottom rails may be over the maximum sizes. But the minimum sizes will not change.
	2 1/2" Louver	3" – 4"	
	3 1/2" Louver	3" – 4 1/2"	
	4 1/2" Louver	3" – 5"	
	5 1/2" Louver	3" – 5 1/2"	
H >=48"	1 1/4" Louver	3 1/2" – 4"	
	2 1/2" Louver	3 1/2" – 4 1/2"	
	3 1/2" Louver	3 1/2" – 5"	
	4 1/2" Louver	3 1/2" – 5 1/2"	
	5 1/2" Louver	3 1/2" – 6"	

T-POST

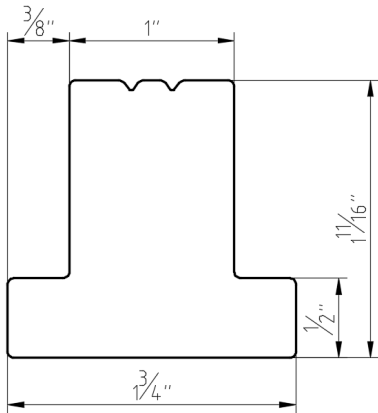

1" T-Post

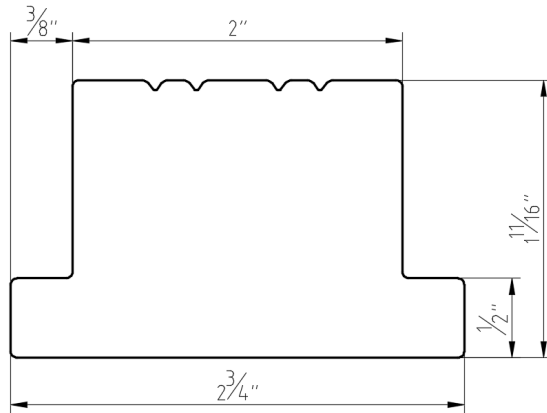

2" T-Post

T-Posts divide a window vertically into sections. It can be used to match the design of a window that has a natural break, mullions, accommodate panel configurations that require more than one panel, or just for aesthetic purposes. Multiple T-Posts can be used for a single opening.

Always measure from the left side of the window or shutter frame to the center of each T-Posts. **(SEE MEASURING GUIDE PAGE 17 FOR IMPORTANT INSTRUCTION)**

To the right is a T-Post attached to a Deco II Frame (the picture is from behind the frame). The T-Post is notched out so that the face sits on the light stop edge. The holes as you can see are pre-drilled and the T-Post is labeled **Top** and **Bottom**.

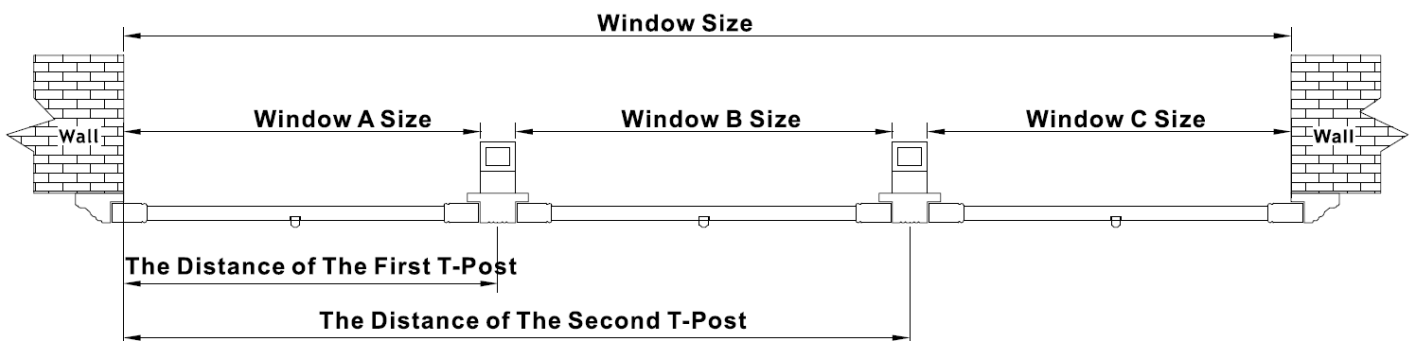
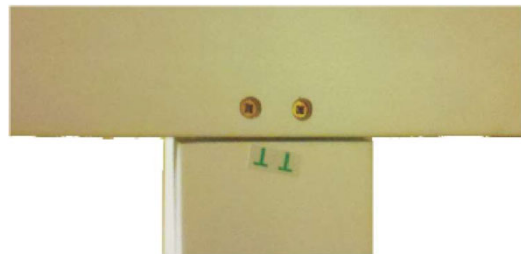

BAY POST

Measurement

Bay posts are T-posts specifically designed for bay windows. These posts are angled at 135 degrees in order to make the bend of the bay window.

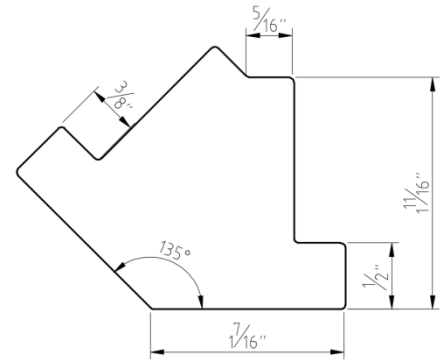

Bay Post

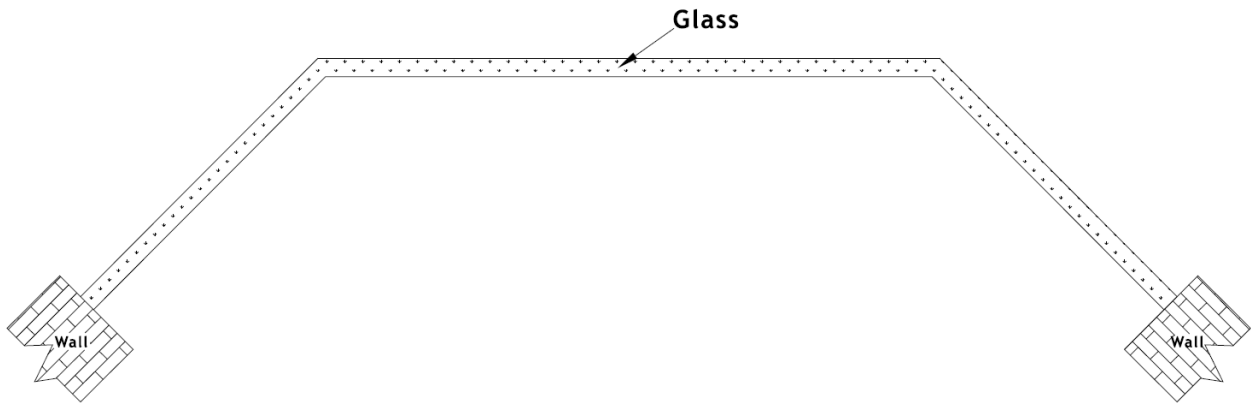

L Frame inside Mount

Maximum Frame to Frame size represents:

Left and Right Opening: measurement from the edge of the frame to the corner of the opening.

Center Opening: Measurement from the left corner to the right corner.

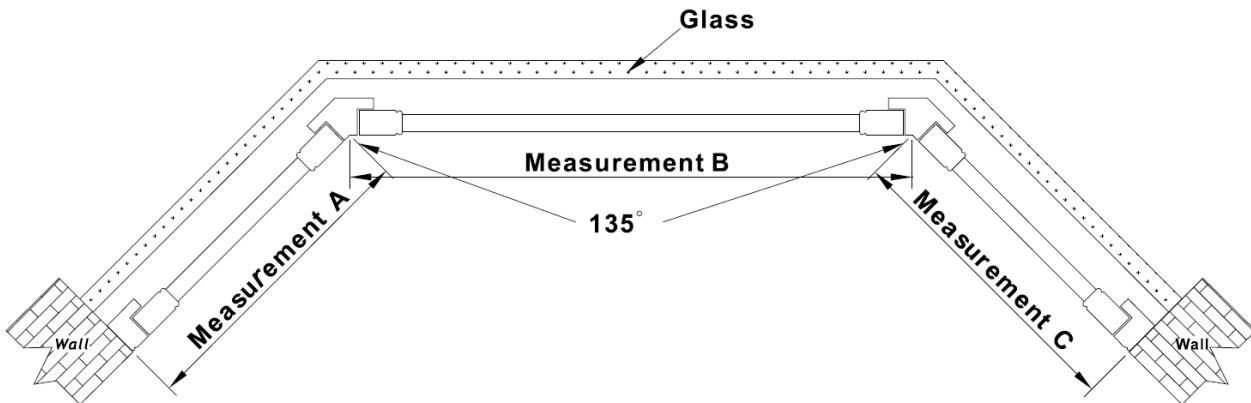

Z Frame inside Mount

Maximum Frame to Frame Size represents:

Left and Right Opening: measurement from the edge of the frame to the corner of the opening.

Center Opening: Measurement from the left corner to the right corner.

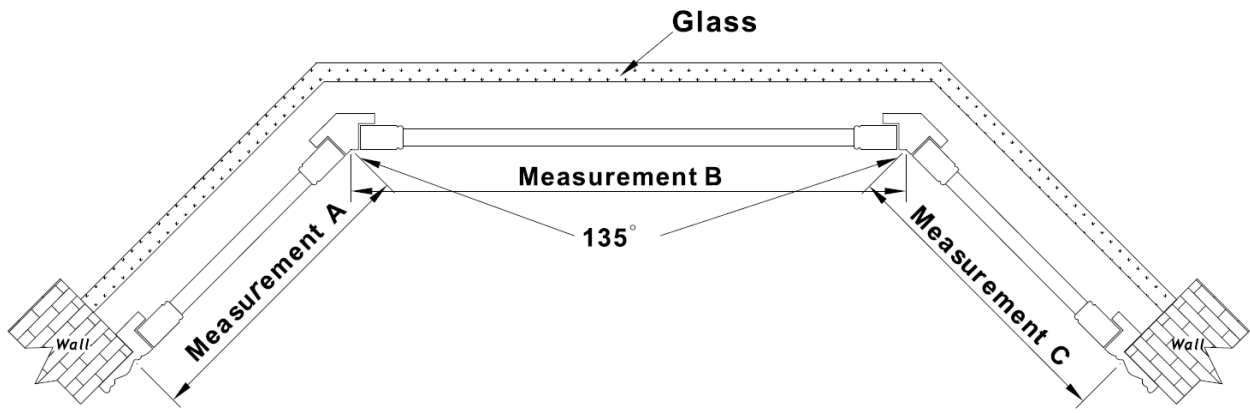

L Frame outside Mount

Maximum Frame to Frame size represents:

Left and Right Opening: measurement from the edge of the frame to the corner of the opening.

Center Opening: measurement from the left corner to the right corner.

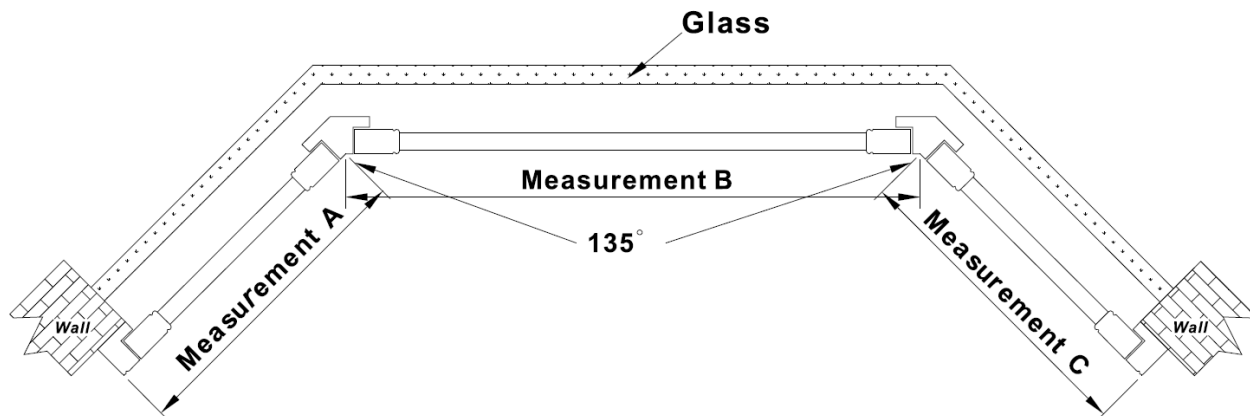

CORNER POST

Measuring

Provide the maximum Frame to Frame size, which is the measurement from the edge of the frame (or one corner of the opening) to the other corner of the opening (assuming there are no protrusions at the corner).

If objects protruding out from the corner you must use outside mount.

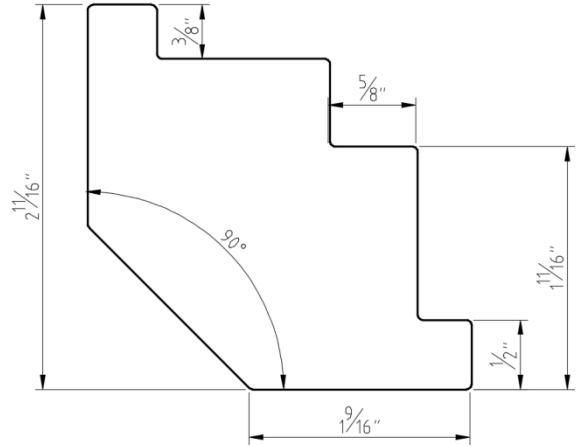

Corner Post

Outside Measuring & Mounting

Maximum Frame to Frame size represents the measurement from the edge of the frame to the corner of the opening (assuming there are no protrusions at the corner).

If there are objects protruding out of the corner use outside mount.

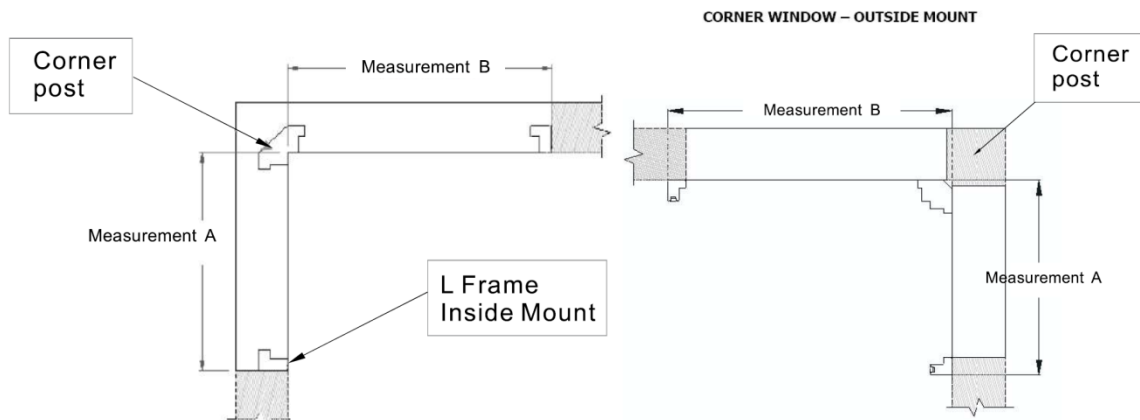

Inside Measuring & Mounting

Provide the measurement from one corner of the opening to other corner (assuming there are no protrusions at the corner). If objects protrudes out from the corner you must use outside mount.

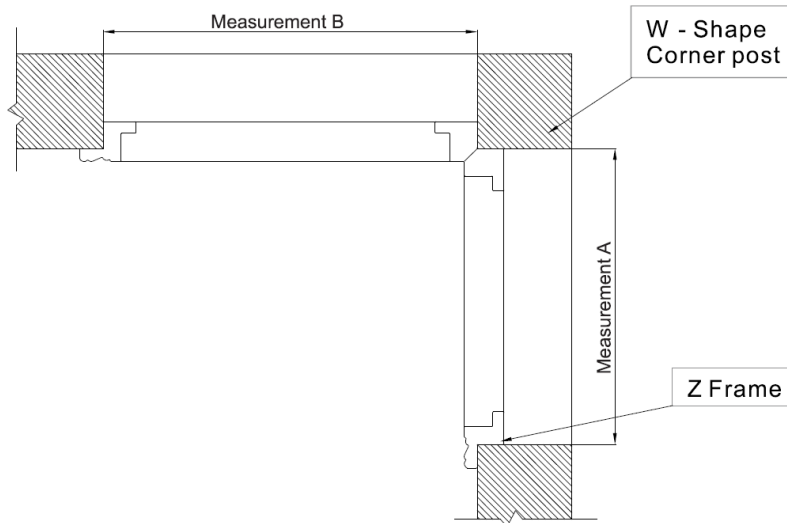

W-Post

For a corner window where the drywall comes out to make a 90 degree angle a W-Post may be used.

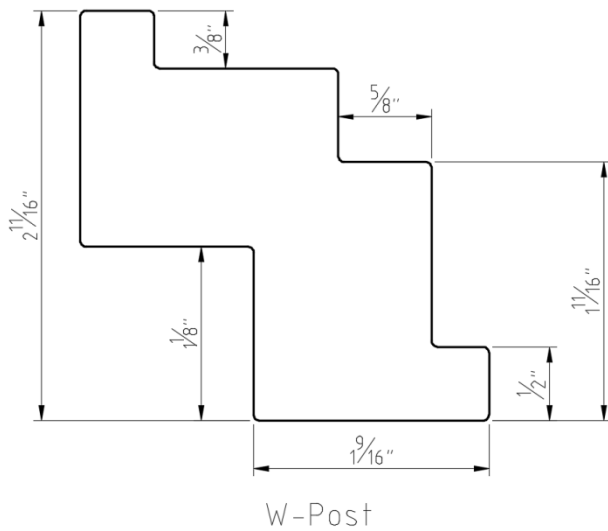

PANEL CONFIGURATIONS

Single Panel



Two Panels

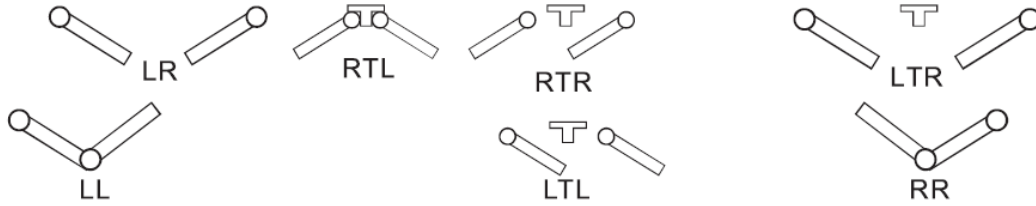

Three Panels

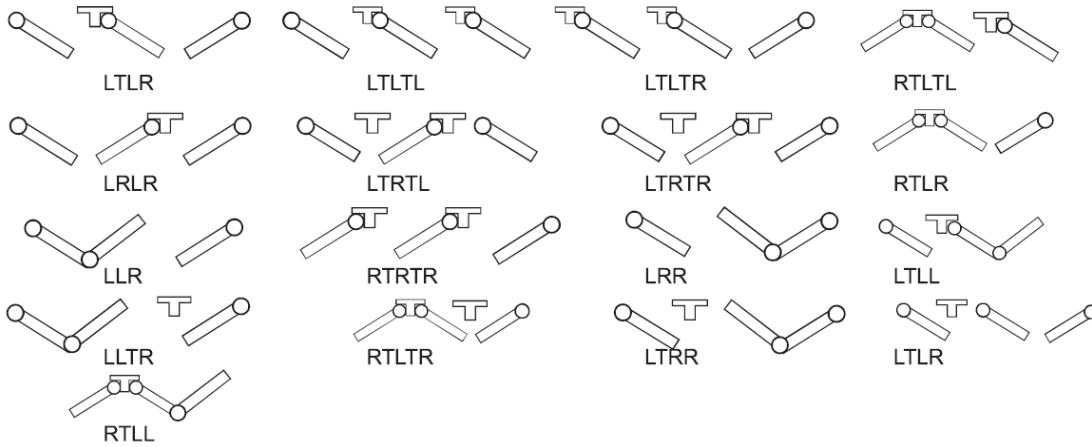

Four Panels

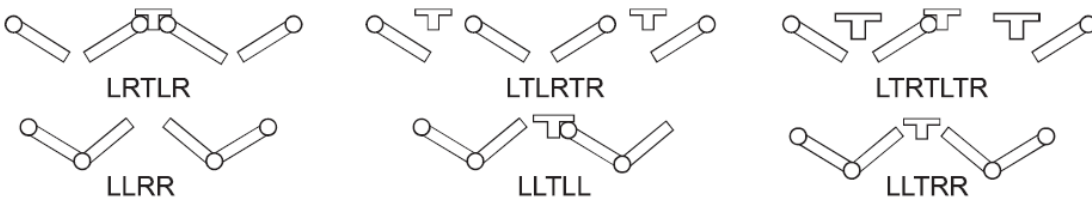

Five Panels

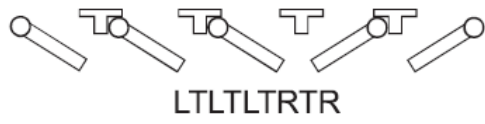
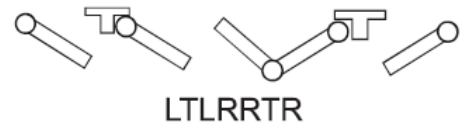

Six Panels

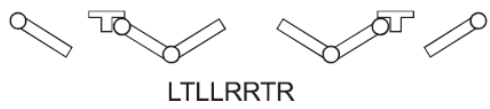

Eight Panels



BYPASS SHUTTERS

Closed Track System is where the louvers have to be in the closed position in order for the panels to pass each other.

Open Track System is where the panels can remain in the open position and still pass each other without the louvers hitting. This option does bring the shutter more into the room to allow for the open louvers.

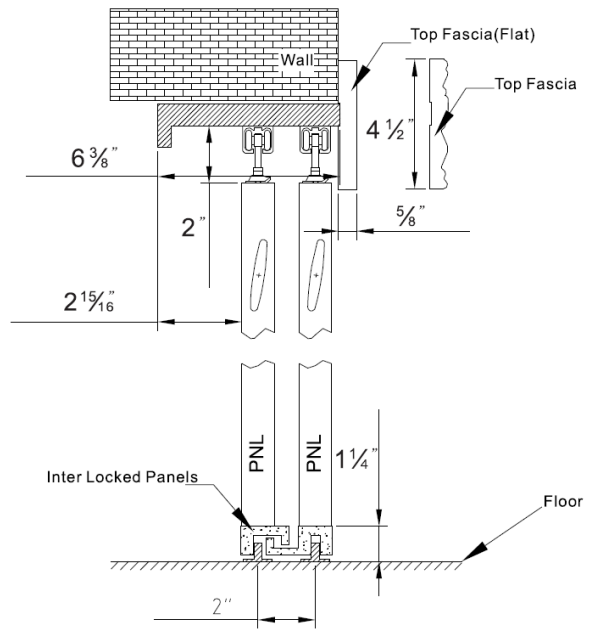
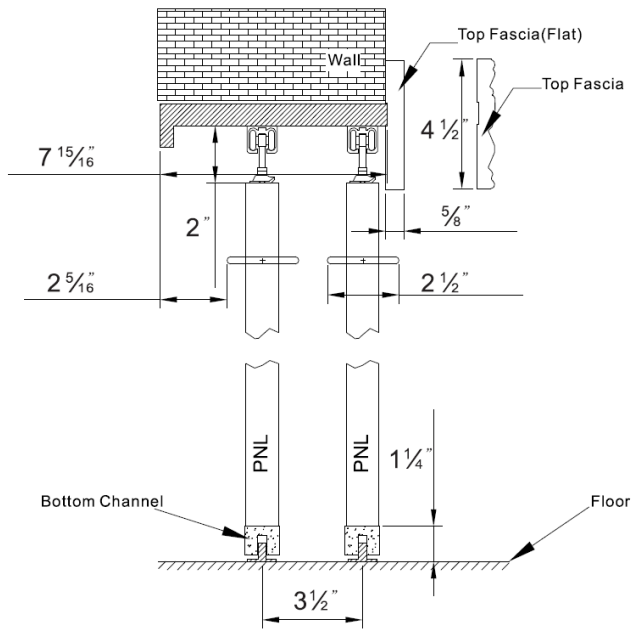
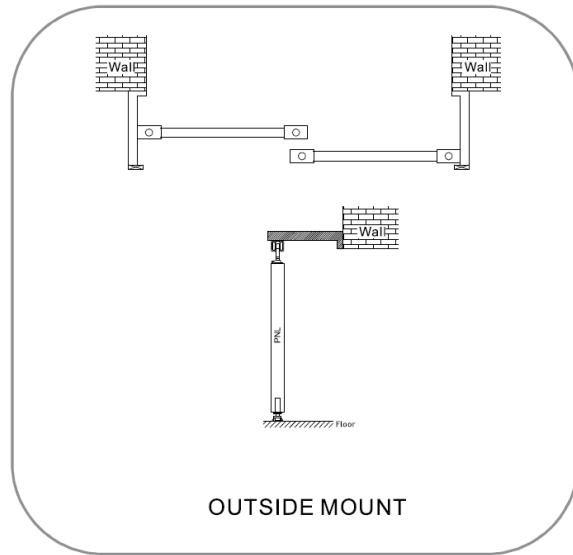
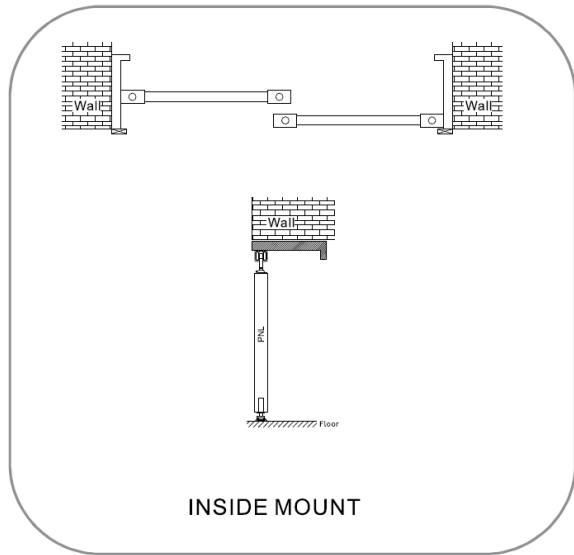

BI-FOLD SHUTTERS

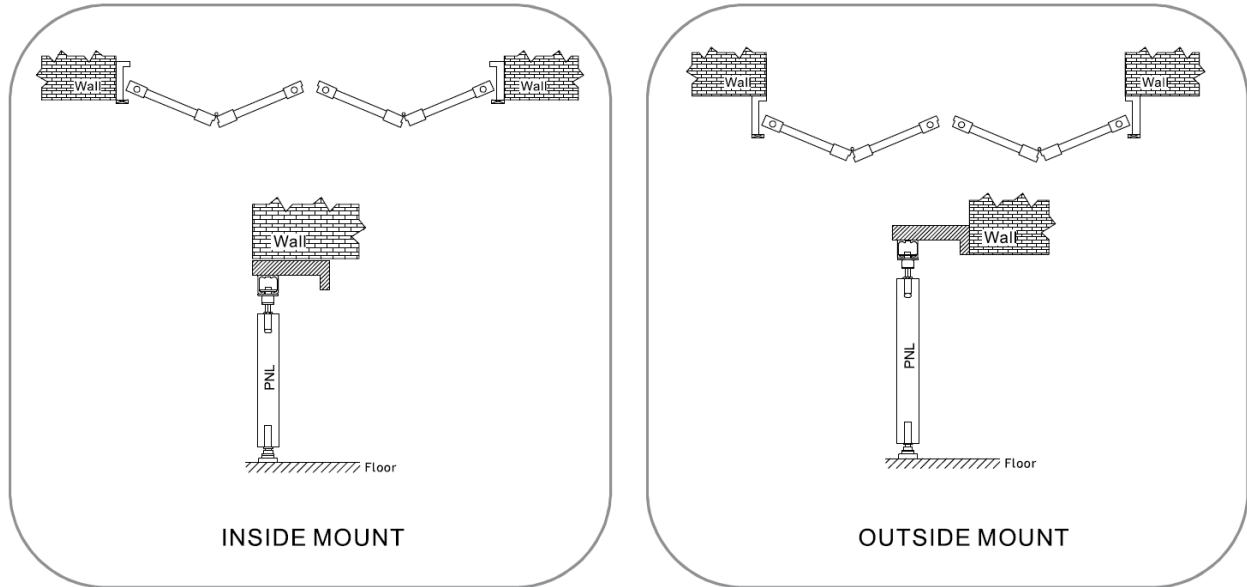

Exus attaches light stop on the inside of the vertical legs for sliders.

This gives a block of wood on the inside to secure your side board width.

Fascia is 4 1/2" wide.

The standard return on the fascia from face to back is 615/16" x 4 1/2".

The standard support legs are 6 5/16" wide for all closed bypass and all bi-fold track systems

Please add the standard support leg size for open bypass shutters here as well.

The side fascia that covers the support legs are 3/8" x 1 1/4".

There is approximately 1/8" distance from the louvers to the wall with the louvers in the open position if the frame were to sit flush against the wall.

TRACK OPENING CONFIGURATION

Indicate the opening types by using the position of the panels on the track working form left to right. Please refer to the opening configuration under Bi-Fold track configurations on Page 50.

Support brackets may be visible from different elevations.

These brackets should be preinstalled on the header board before positioning the frame in the window.

Special wrenches are supplied in the box for height adjustments for the panels.

There will be one overlap on the stiles for a standard by-pass shutter.

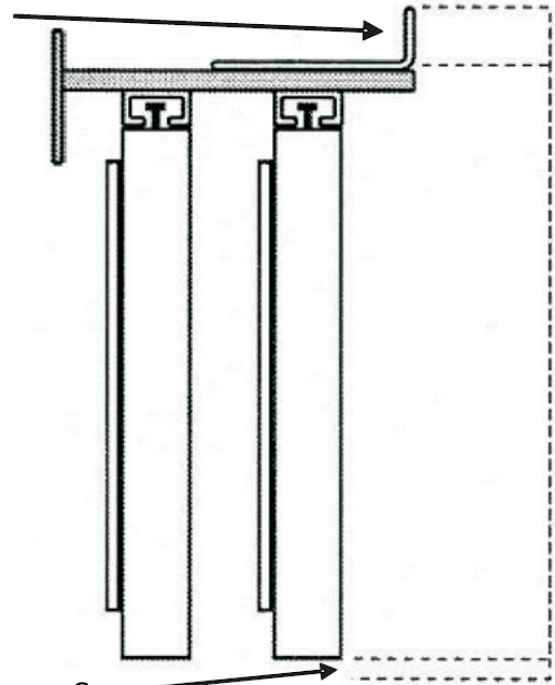

Exus has a Floor Clearance Gap

MULTI-FOLD TRACK SHUTTERS

Maximum single panel width for multi-fold is 20”.

Panel configuration: LLLL, RRRR, or LLLLRRRR.

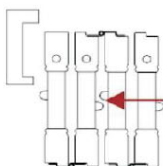
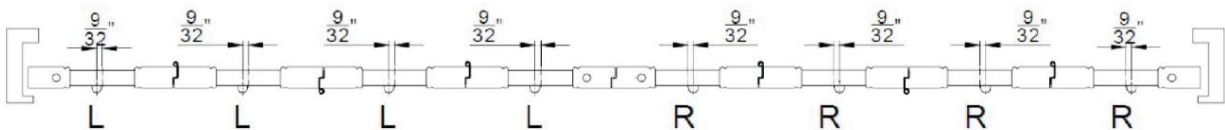

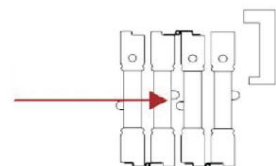

Tilt Rods are offset by $\frac{9}{32}$ " to the left for left panels and to the right for right panels to enable the shutters to fold completely.

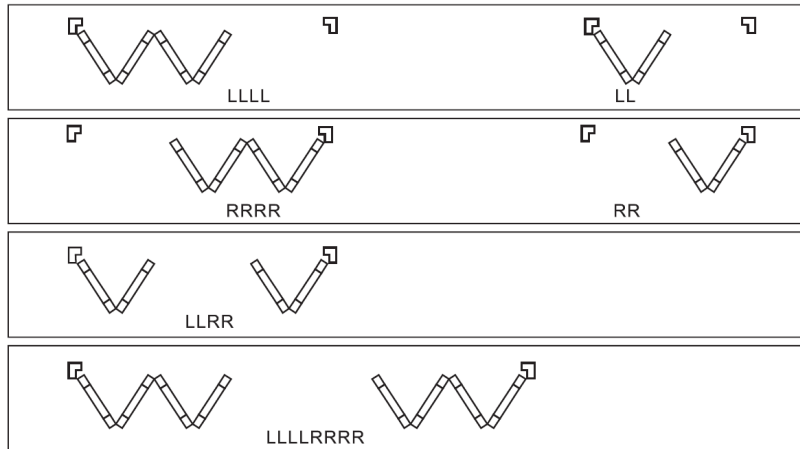

BI-FOLD TRACK CONFIGURATION

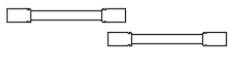
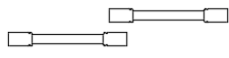
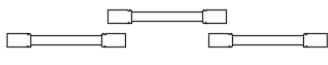

BYPASS TRACK CONFIGURATION

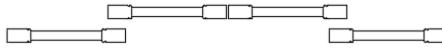
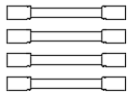
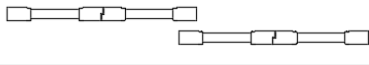
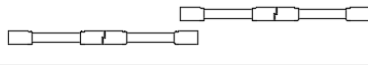
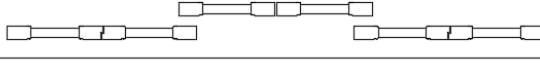
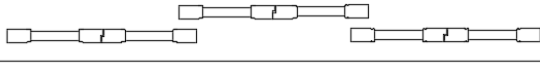
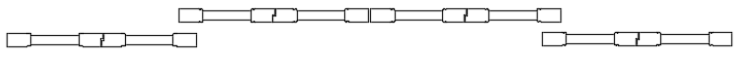
Panel Configuration	Illustrated Example Top View	
1L/1R*	 B/B	 F/F
1L/1C/1R		
1L/1L/1L		
1L/1C/1C/1R		
1L/1L/1L/1L		
2L/2R*	 B/B	 F/F
2L/1C/1C/2R		
2L/2C/2R		
2L/2C/2C/2R		

*Mark **B/F** for Back/Front, or **F/B** for Front/Back configuration on your order form in the SpecialInstructionsbox. This allows for correct placement of light-stops on closed-tracks.

FRENCH DOOR

Door without lock

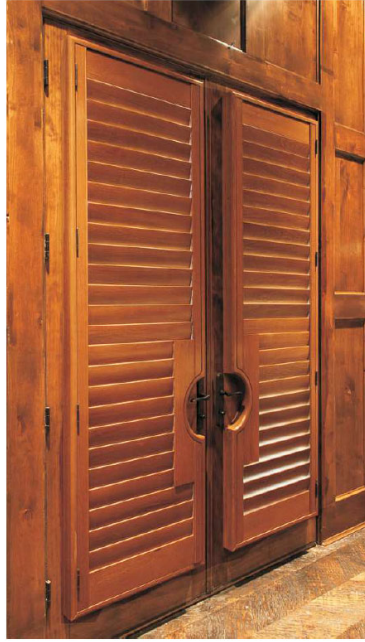
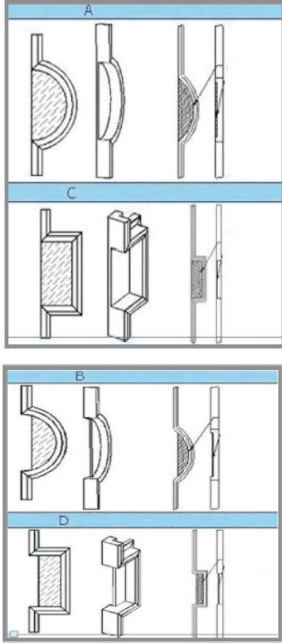

A French door cutout is required if the handle or lock comes into the space of where the shutter will hang. You can choose a half circle or square cutout, or you can just have the frame notched out if you do not need much clearance. This is shown below.

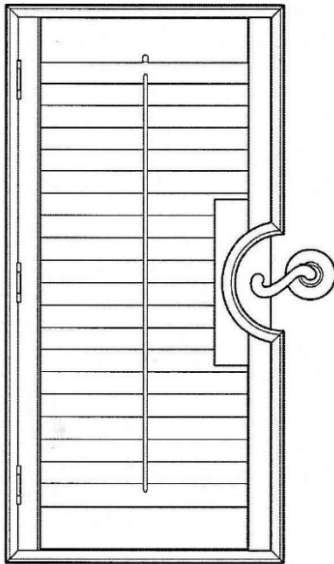

L Frame with Curved Cut-Out
(Surcharge applies)

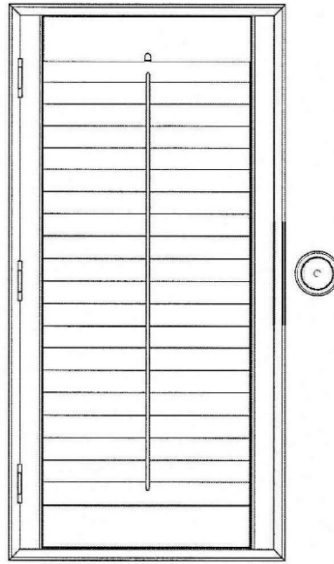

L Frame with Notch-Out
(Surcharge applies)

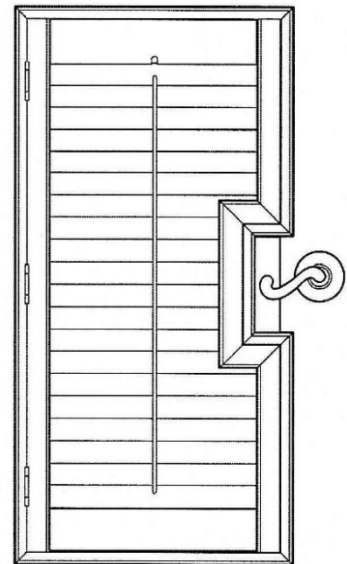

L Frame with Rectangular
Cut-Out (Surcharge applies)

CAFE SHUTTER

Cafe shutters usually cover the bottom portion of your window and typically do not have a frame across the top of your window. When ordering, please provide the finished height and window height for these shutters. If you want the frame to exceed the height of the cafe shutter, the extra surcharge covers the additional frame that goes beyond the height of the shutter.

If the frame exceeds the cafe shutter panel, please put details in special instructions to clarify difference in measurements for frame and panels. Surcharge applies if frame exceeds the panel by 5”.

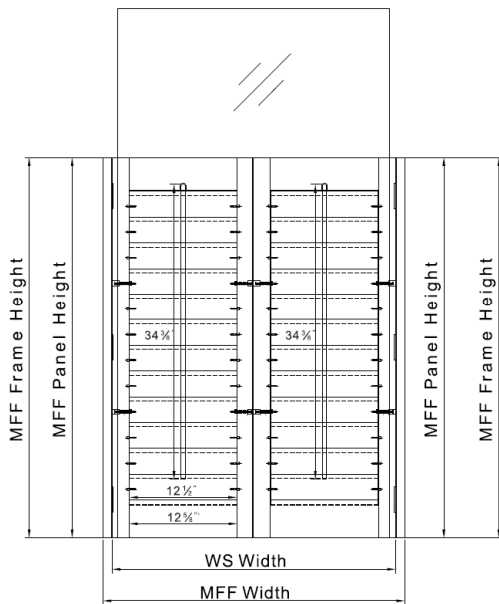

Frame Height = Panel Height

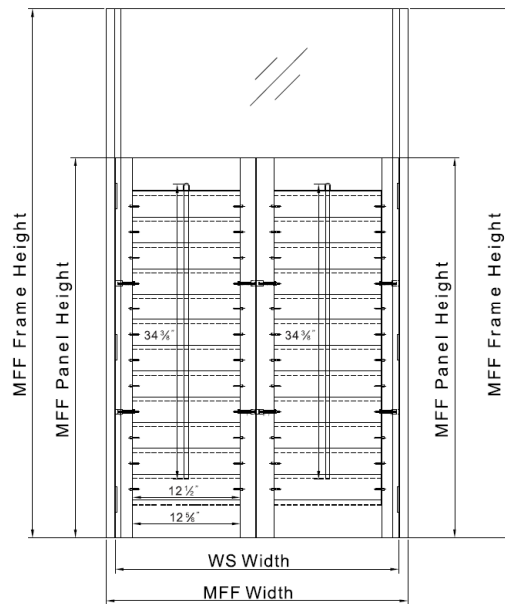

Frame Height > Panel Height

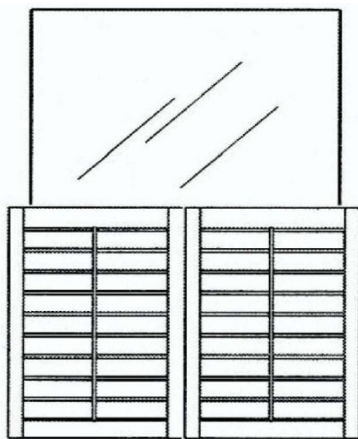

Shown as 2 Sided

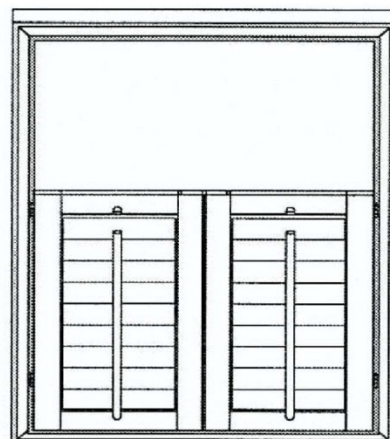

Shown as 4 Sided

COMMON SPECIAL SHUTTER

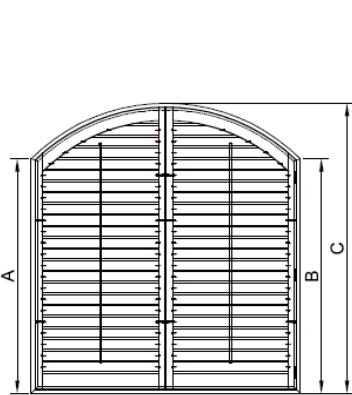

Full Arch

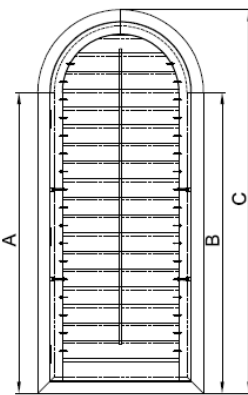

Perfect Arch

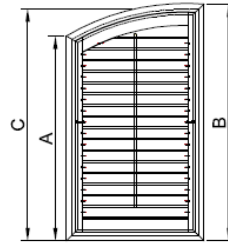

1/2 Arch Left

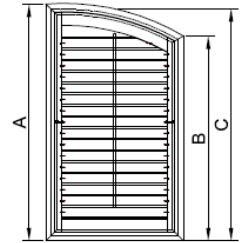

1/2 Arch Right

COMMON SPECIAL SHUTTER CONTINUED

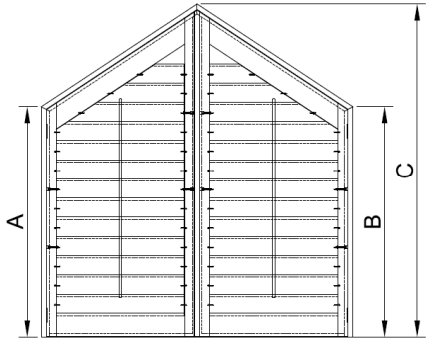

Rake

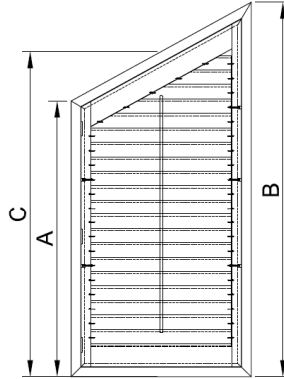

1/2 Rake Left

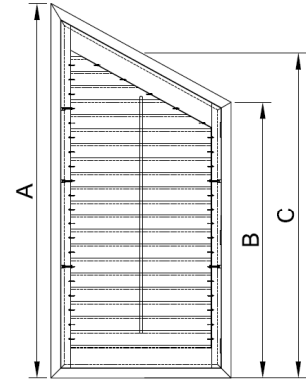

1/2 Rake Right

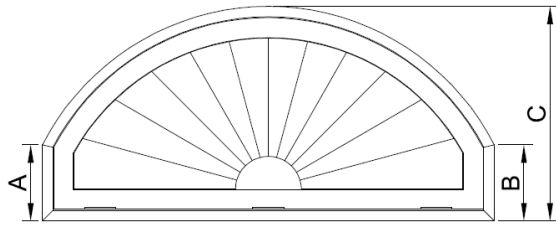

Elongated Eyebrow Sunburst

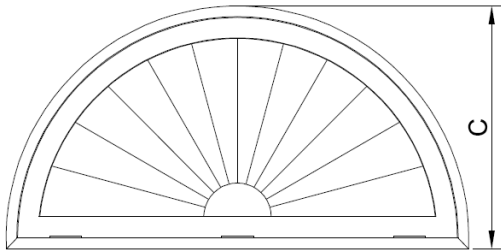

Half Round Sunburst

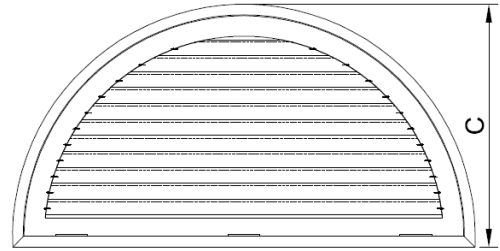

Horizontal Louvered Arch

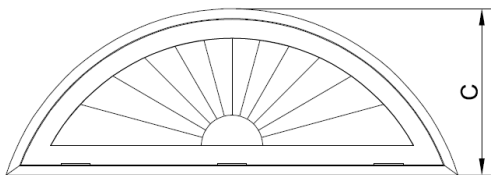

Eyebrow

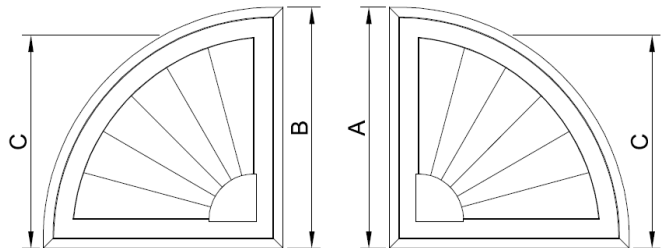

Left And Right Quarter Round Sunburst

DOUBLE HUNG

Sunbursts or horizontal arches can be combined with regular shaped shutters to give the design more sophistication and flexibility. For arched top/rake top panels there is always a possibility that not all of the louvers will rotate and some of the ones that do may not rotate fully.

Horizontal T-Posts may be used to separate the two sections of double hung shutters to eliminate the light gap at no additional charge.

Hub: This is a rounded piece of material located in the center of a sunburst type shutter.

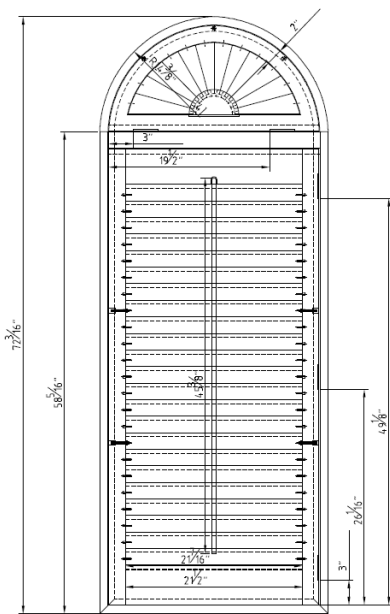

Sunburst on Top of Rectangle
(Require a Horizontal T-Post)

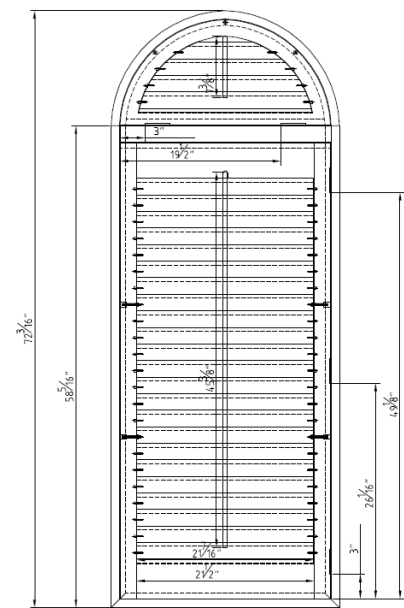
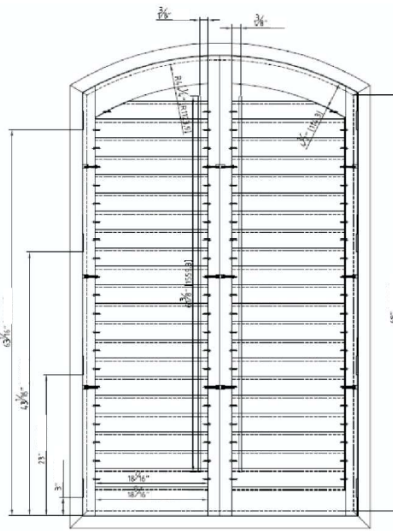

Horizontal Arch on Top of Rectangle
(Require a Horizontal T-Post)

Double Hung shutters offer unique adjustability. However, certain wide openings may cause a sagging problem.

There will be a 1/8" gap between the panels.



RAISED PANEL

A raised panel has a solid bottom to the shutter panel. This creates an elegant high-end look providing a three dimensional design due to the border around panel.



Raised Panel →



↑
Raised Panel

OTHER SPECIALTY SHAPES

Provide the measurements per diagram. For inside mount, template is required.

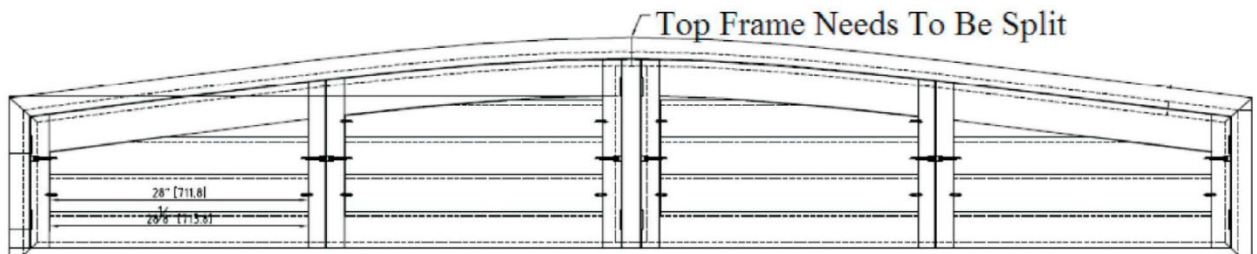
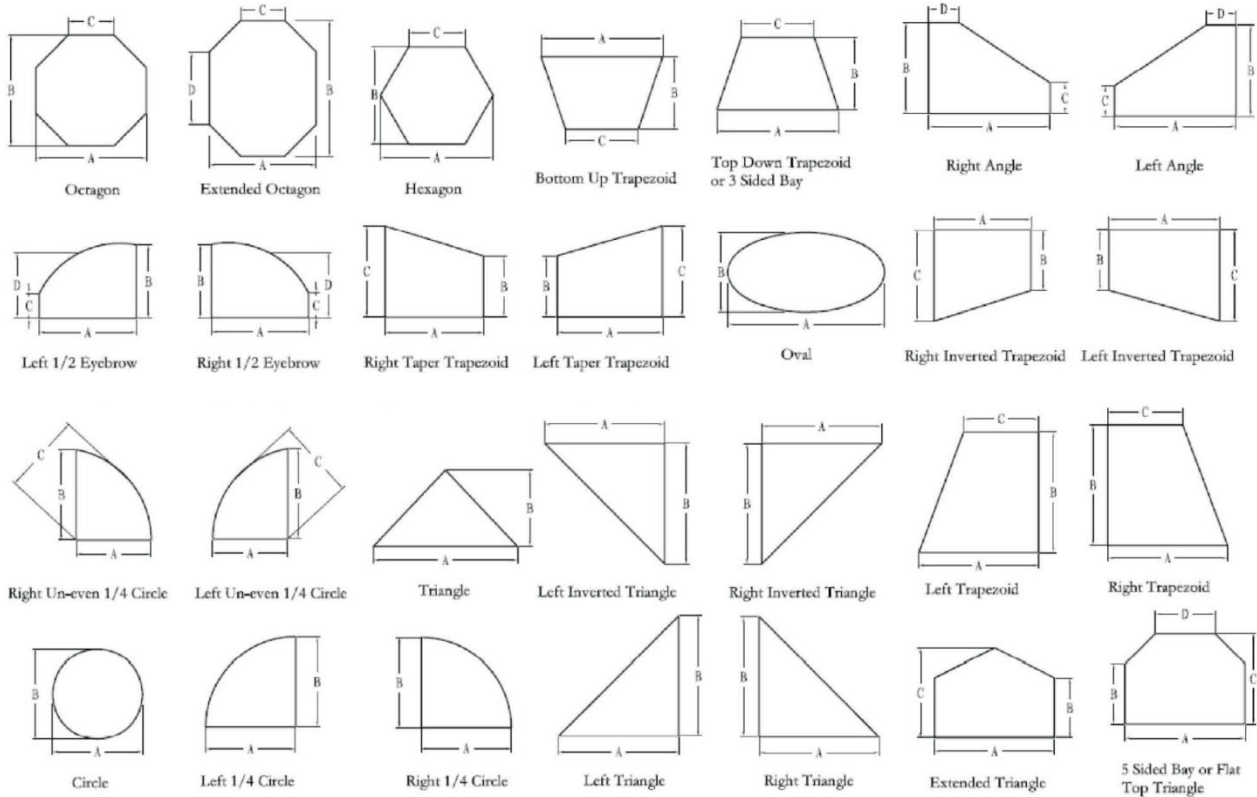

For shipping reasons, Exus may need to cut the frame at locations to avoid damage. For example, the shutter above is almost 135" and our CNC machine is not designed to handle material dimensions over 110". In this instance you may want to tell your customer these limitations and explain that there will be a visible seam in the middle of the frame.



SHUTTER WARRANTY

Exus Shutters have a **Limited Lifetime Warranty** for as long as the original purchaser owns the shutter(s), PROVIDED THAT such products were manufactured or assembled exclusively from original materials and components. Any resale or other transfer of the product and/or materials voids this warranty.

Painted Wood Shutters and Premium Faux Shutters (except for primed shutters) come with a Limited Lifetime warranty on colorfastness of solid colors. Stained Wood Shutters come with a Three Year Limited Lifetime warranty on colorfastness.

This warranty does not cover any condition of damage to the shutter or window from unauthorized repairs, motorized devices, accidents, alterations, misuse, abuse, act of God, normal wear and tear, exposure to elements, excessive humidity, or failure to follow the Exus approved instructions with respect to measurement, installation, cleaning and/or maintenance. Improper, inappropriate, or unauthorized replacement parts, repairs or maintenance voids this warranty. Painting or repainting of Exus shutters by any person or company other than Exus voids all warranty. Exus shutters manufactured outside of specification on width or height at the customer request will carry no mechanical, structural, or finish warranty.

This warranty excludes all liability for removal of the shutter and reinstallation in the same or another window or damage due to the window frame, glass or any other portion of the window. Due Exus shutters being a natural product, variations in color, grain, and texture in products is considered normal and is not subject to warranty claims. Exus or its licensed distributors/dealers are not able to guarantee exact matches on subsequent orders. Returns cannot be authorized due to these normal variations.

To obtain warranty service, please contact the dealer from whom you purchased the product. Repair or remake of defective product is at the sole discretion of Exus. Repair or remake of defective products is the sole remedy under this warranty and in no event shall Exus or its licensed distributors or dealers be liable for costs to remove and/or reinstall the product. Repairs will be made with only like or similar parts. This warranty does not include shipping charges, costs of labor for measuring, installation, or trip charges. Warranty claims must be accompanied by proof of purchase, as well as details regarding the problem, location of the product, etc. All warranty claims must be accompanied by an Exus RMA form with all pertinent information filled out.

This warranty is EXCLUSIVE AND IN LIEU OF ALL OTHER OBLIGATIONS, LIABILITIES OR WARRANTIES. All other warranties, both expressed and implied, are explicitly disclaimed. In no event shall Exus Shutters or licensed Exus distributors/dealers be liable or responsible for INCIDENTAL OR CONSEQUENTIAL DAMAGES, or for any other direct or indirect damage, loss, cost, expense or fee. Some states do not allow the exclusion or limitation of implied warranties, or incidental or consequential damages, so the above limitation may not apply to your state. This warranty gives you specific legal rights, any you may also have other rights which vary from state to state.



Exus Shutters

1221 Champion Circle Suite 115

Carrollton, TX 75006

Toll Free: (877) 228-EXUS (3987)

Phone: (972) 236-7470

Fax: (972) 242-5224

E-mail: orders@exusshutters.com



1221 Champion Cir. Suite 115 info@exusshutters.com
 Carrollton, TX 75006 marleinev@exusshutters.com
 TEL: 877-228-EXUS(3987) FAX: 972-242-5224

3340-D Greens Rd, Ste. 200 tannerc@exusshutters.com
 Houston, TX 77032 lauries@exusshutters.com
 TEL: 832-672-4928

STANDARD SHUTTER ORDER FORM

Please Specify Shutter Type:	Shutter Type <i>(select one)</i>								White Glove	Stile Type <i>(select one)</i>			LR Stiles Type <i>(select one)</i>	
	<input type="checkbox"/> LIN	<input type="checkbox"/> FAUX	<input type="checkbox"/> FLAT	<input type="checkbox"/> RUS	<input type="checkbox"/> CHAT	<input type="checkbox"/> VEN	<input type="checkbox"/> SON	<input type="checkbox"/> DES	<input type="checkbox"/>	<input type="checkbox"/> BEADED	<input type="checkbox"/> SMOOTH	<input type="checkbox"/> ASTRAGAL	<input type="checkbox"/> RABBIT	

Standard Order Form:	Dealer Acct #:				Sidemark:				Order Date:			
	Dealer Name:				Tel:			Cell:			Page	of
	Tel:				Install/				Measured By:			
	Fax:				Shipping							
	Email:				Address:							

#	Room	Meas. W/F	Measurement		Mt. I/O	Frame Type	Frame Sides	Color	Hinge Color	LVR Size	Tilt	Panel Config	Divider Rail	T Post		Special Instructions
			Width	Height										1st	2nd	
1																
2																
3																
4																
5																
6																
7																
8																
9																
10																
Special Instructions:																

GENERAL INSTRUCTIONS: THESE INSTRUCTIONS APPLY TO ALL WINDOW OPENING TYPES

- See Exus Shutter Manual p. 27 for buildout and extension requirements
- Panel max width is 44" for wood and 36" for faux
- Panel max height is 120". A divider rail is added when panels exceed 74"
- Min charge per opening is 6 sq.ft.
- Min order quantity is 6 sq.ft.
- Min panel size is 8" wide x 18" high

Meas. Type	(W) Window Opening	(F) Frame to Frame		
Mount Type	(IM) Inside Mount	(OM) Outside Mount		
Tilt	(C) Center	(H) Hidden	(O) Offset	(I) Ideal
Hinges	(SW) Snow White	(SC) Swiss Coffee	(OB) Oil Bronze	(AB) Antique Brass
	(BB) Bright Brass	(SS) Stainless Steel	(BL) Black	(HH) Hidden Hinge

Waiver of Liability on Inside and Semi-inside Mount Applications: Inside or semi-inside mount frames may hinder the removal of windows or interior screens for cleaning and maintenance purpose. The retailer has the responsibility to disclose these limitations to the end user at the time of sale and waives any liabilities if the inside/semi-inside mount application is deemed unacceptable to the end user after installation (irregardless of whether measure or installation was provided by the retailer or through our Exus Shutters turnkey program. I acknowledge that the information above is accurate and authorize Exus Shutters to place the above order. The order is not subject to changes or cancellation.

Signature: _____ Date: _____

Please Specify Shutter Type:	Shutter Type <i>(select one)</i>								White Glove	Stile Type <i>(select one)</i>			LR Stiles Type <i>(select one)</i>	
	<input type="checkbox"/> LIN	<input type="checkbox"/> FAUX	<input type="checkbox"/> FLAT	<input type="checkbox"/> RUS	<input type="checkbox"/> CHAT	<input type="checkbox"/> VEN	<input type="checkbox"/> SON	<input type="checkbox"/> DES	<input type="checkbox"/>	<input type="checkbox"/> BEADED	<input type="checkbox"/> SMOOTH	<input type="checkbox"/> ASTRAGAL	<input type="checkbox"/> RABBIT	

Specialty Shape Order Form:	Dealer Acct #:				Sidemark:				Order Date:			
	Dealer Name:				Tel:				Cell:			
	Tel:				Install/				Measured By:			
	Fax:				Shipping							
	Email:				Address:							

#	Room	Special Shape (See Ref.)	Meas. W/F	(A) Width	(C) Left Side Leg	(B) Middle Height	(D) Right Side Leg	(Sunburst Only) Bottom (Frame/Base)	Mt. I/O	Frame Type	Frame Sides	Shutter Color	Hinge Color	LVR Size	Tilt	Panel Config	Divider Rail	Special Instructions
1																		
2																		
3																		
4																		
5																		

REFERENCE - COMMON SPECIAL SHAPES (please choose the desired shape from below and enter code inside the bracket into "SPECIAL SHAPE" column above)

REFERENCE - COMMON SPECIAL SHAPES										CUSTOM SHAPE (CS)	
ARCH (AR)		1/2 ARCH-LEFT (1/2 AR-L)		1/2 ARCH-RIGHT (1/2 AR-R)		1/2 CIRCLE SUNBURST (1/2 CSB)				Sketch in the desired custom shape and note in the drawings all the necessary measurements.	
RAKE (RK)		1/2 RAKE-LEFT (1/2 RK-L)		1/2 RAKE-RIGHT (1/2 RK-R)		EYEBROW SUNBURST (ESB)					

GENERAL INSTRUCTIONS: THESE INSTRUCTIONS APPLY TO ALL WINDOW OPENING TYPES

- See Exus Shutter Manual p. 27 for buildout and extension requirements
- Panel max width is 44" for wood and 36" for faux
- Panel max height is 120". A divider rail is added when panels exceed 74".
- Min charge per opening is 6 sq.ft.
- Min order quantity is 6 sq.ft.
- Min panel size is 8" wide x 18" high

Meas. Type	(W) Window Opening	(F) Frame to Frame		
Mount Type	(IM) Inside Mount	(OM) Outside Mount		
Tilt	(C) Center	(H) Hidden	(O) Offset	(I) Ideal
Hinges	(SW) Snow White	(SC) Swiss Coffee	(OB) Oil Bronze	(AB) Antique Brass
	(BB) Bright Brass	(SS) Stainless Steel	(BL) Black	(HH) Hidden Hinge

Waiver of Liability on Inside and Semi-inside Mount Applications: Inside or semi-inside mount frames may hinder the removal of windows or interior screens for cleaning and maintenance purpose. The retailer has the responsibility to disclose these limitations to the end user at the time of sale and waives any liabilities if the inside/semi-inside mount application is deemed unacceptable to the end user after installation (irregardless of whether measure or installation was provided by the retailer or through our Exus Shutters turnkey program. I acknowledge that the information above is accurate and authorize Exus Shutters to place the above order. The order is not subject to changes or cancellation.

Signature: _____ Date: _____

Please Specify Shutter Type:	Shutter Type (select one)						White Glove	Stile Type (select one)		
	<input type="checkbox"/> LIN	<input type="checkbox"/> FAUX	<input type="checkbox"/> FLAT	<input type="checkbox"/> RUS	<input type="checkbox"/> CHAT	<input type="checkbox"/> VEN	<input type="checkbox"/> SON	<input type="checkbox"/> DES	<input type="checkbox"/>	<input type="checkbox"/> BEADED

French Door Cut Out Order Form:	Dealer Acct #:	Sidemark:		Order Date:
	Dealer Name:	Tel:	Cell:	Page of
	Tel:	Install/	Measured By:	
	Fax:	Shipping		
	Email:	Address:		

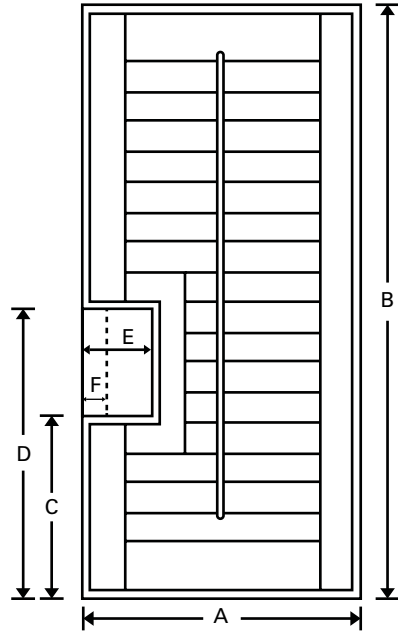

Handle on the	Room	Frame Type	Measure Type	LVR Size	Sides	Panel Config	Shutter Color	Hinge Color	Tilt
<input type="checkbox"/> LEFT <input type="checkbox"/> RIGHT									

- A: _____ Width designation
- B: _____ Height designation
- C: _____ Bottom of shutter to bottom of cut-out
- D: _____ Bottom of shutter to top of cut-out
- E: _____ Width of cut-out

If you need to recess the plate on cut-out, please fill out dimension (F)

F: _____ Distance from outside of frame to start of recessed plate

Frame Extension: _____

Special Instructions	
----------------------	--

Cut Out Type				Surcharges	
<input type="checkbox"/> 1A	<input type="checkbox"/> 1B	<input type="checkbox"/> 2A	<input type="checkbox"/> 2B	Standard 3/4" and 1" Frame Extension = 5%	
				Custom Extension = 10%	

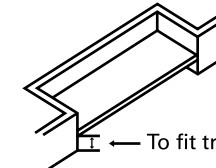

TRIM PROJECTION

Plate inside of the cut out will be raised to avoid existing protruded molding.

GENERAL INSTRUCTIONS: THESE INSTRUCTIONS APPLY TO ALL WINDOW OPENING TYPES

- See Exus Shutter Manual p. 27 for buildout and extension requirements
- Panel max width is 44" for wood and 36" for faux
- Panel max height is 120". A divider rail is added when panels exceed 74"
- Min charge per opening is 6 sq.ft.
- Min order quantity is 6 sq.ft.
- Min panel size is 8" wide x 18" high

Meas. Type	(W) Window Opening	(F) Frame to Frame		
Mount Type	(IM) Inside Mount	(OM) Outside Mount		
Tilt	(C) Center	(H) Hidden	(O) Offset	(I) Ideal
Hinges	(SW) Snow White	(SC) Swiss Coffee	(OB) Oil Bronze	(AB) Antique Brass
	(BB) Bright Brass	(SS) Stainless Steel	(BL) Black	(HH) Hidden Hinge

Waiver of Liability on Inside and Semi-inside Mount Applications: Inside or semi-inside mount frames may hinder the removal of windows or interior screens for cleaning and maintenance purpose. The retailer has the responsibility to disclose these limitations to the end user at the time of sale and waives any liabilities if the inside/semi-inside mount application is deemed unacceptable to the end user after installation (irregardless of whether measure or installation was provided by the retailer or through our Exus Shutters turnkey program. I acknowledge that the information above is accurate and authorize Exus Shutters to place the above order. The order is not subject to changes or cancellation.

Signature: _____ Date: _____

Please Specify Shutter Type:	Shutter Type (select one)						White Glove	Stile Type (select one)		
	<input type="checkbox"/> LIN	<input type="checkbox"/> FAUX	<input type="checkbox"/> FLAT	<input type="checkbox"/> RUS	<input type="checkbox"/> CHAT	<input type="checkbox"/> VEN	<input type="checkbox"/> SON	<input type="checkbox"/> DES	<input type="checkbox"/>	<input type="checkbox"/> BEADED

French Door Notch Out Order Form:	Dealer Acct #:	Sidemark:		Order Date:
	Dealer Name:	Tel:	Cell:	Page of
	Tel:	Install/	Measured By:	
	Fax:	Shipping		
	Email:	Address:		

Handle on the	Room	Frame Type	Measure Type	LVR Size	Sides	Panel Config	Shutter Color	Hinge Color	Tilt
<input type="checkbox"/> LEFT <input type="checkbox"/> RIGHT									

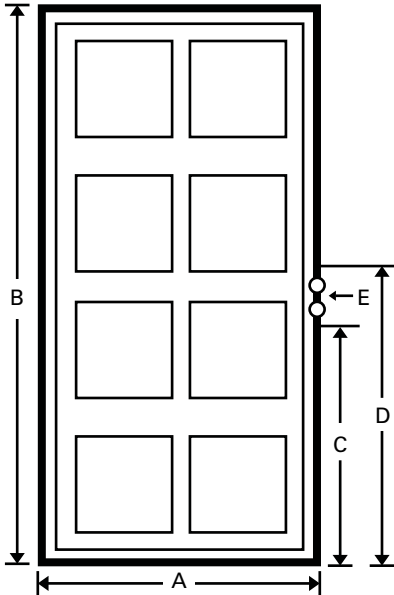

- A: _____ Shutter Width, Frame to Frame
- B: _____ Shutter Height, Frame to Frame
- C: _____ Bottom of Notch-Out, From Bottom of Shutter
- D: _____ Top of Notch-Out, From Bottom of Shutter
- E: _____ Size of Notch-Out (3/4" Maximum)

Surcharges
Notch Out = \$10
3/4" & 1" Extension = 5%
Custom Extension = 10%
Buildout > 1/2" = 5%

Frame Extension: _____ Buildout: _____

Special Instructions	
----------------------	--

GENERAL INSTRUCTIONS: THESE INSTRUCTIONS APPLY TO ALL WINDOW OPENING TYPES

- See Exus Shutter Manual p. 27 for buildout and extension requirements
- Panel max width is 44" for wood and 36" for faux
- Panel max height is 120". A divider rail is added when panels exceed 74"
- Min charge per opening is 6 sq.ft.
- Min order quantity is 6 sq.ft.
- Min panel size is 8" wide x 18" high

Meas. Type	(W) Window Opening	(F) Frame to Frame						
Mount Type	(IM) Inside Mount	(OM) Outside Mount						
Tilt	(C) Center	(H) Hidden	(O) Offset	(I) Ideal				
Hinges	(SW) Snow White	(SC) Swiss Coffee	(OB) Oil Bronze	(AB) Antique Brass	(BB) Bright Brass	(SS) Stainless Steel	(BL) Black	(HH) Hidden Hinge

Waiver of Liability on Inside and Semi-inside Mount Applications: Inside or semi-inside mount frames may hinder the removal of windows or interior screens for cleaning and maintenance purpose. The retailer has the responsibility to disclose these limitations to the end user at the time of sale and waives any liabilities if the inside/semi-inside mount application is deemed unacceptable to the end user after installation (irregardless of whether measure or installation was provided by the retailer or through our Exus Shutters turnkey program. I acknowledge that the information above is accurate and authorize Exus Shutters to place the above order. The order is not subject to changes or cancellation.

Signature: _____ Date: _____